

**GENERAL CONSTRUCTION NOTES**

- THIS PROJECT IS TO BE CONSTRUCTED IN ACCORDANCE WITH NHDOT STANDARD SPECIFICATIONS FOR ROAD AND BRIDGE CONSTRUCTION, DATED 2010 AND "CONTRACT SPECIFICATIONS OF BEDFORD, NH - DEPARTMENT OF PUBLIC WORKS" OF WHICH THESE PLANS ARE A PART. IN THE EVENT ANY DISCREPANCIES EXIST BETWEEN THESE PLANS AND WRITTEN PORTIONS OF THE CONTRACT SPECIFICATIONS, THE CONTENT OF THE WRITTEN SPECIFICATIONS SHALL PREVAIL.
- ALL WORK SHALL BE COMPLETED WITHIN THE RIGHT-OF-WAY UNLESS SPECIFIED BY THE PLANS OR THE TOWN ENGINEER. ANY WORK REQUIRED ON PRIVATE PROPERTY SHALL BE COORDINATED WITH THE HOMEOWNER AND THE TOWN ENGINEER TO MINIMIZE INCONVENIENCE AND PROVIDE ACCESS TO THE HOMEOWNER. CONTRACTOR SHALL CONTACT TOWN OF BEDFORD, TOWN ENGINEER, FOR LIMITS OF ALL PROPOSED EASEMENTS PRIOR TO CONSTRUCTION.
- CONTRACTOR SHALL VERIFY LOCATION OF UTILITIES PRIOR TO COMMENCEMENT OF THIS WORK.
- NO EXISTING MONUMENTS, BOUNDS OR BENCHMARKS SHALL BE DISTURBED WITHOUT FIRST MAKING PROVISIONS FOR RELOCATION.
- UNSUITABLE MATERIAL, ROOTS AND STUMPS WITHIN THE LIMITS OF ROADBED SHALL BE REMOVED AS ORDERED.
- DIMENSIONS, ANGLES, BEARINGS, AND ELEVATIONS SHOWN ON THESE PLANS HAVE BEEN OBTAINED FROM LIMITED FIELD INVESTIGATIONS AND SURVEY AND MAY NOT ACCURATELY REFLECT ACTUAL FIELD CONDITIONS. IT IS THE RESPONSIBILITY OF THE CONTRACTOR TO FIELD VERIFY PROJECT WORK. ANY DISCREPANCIES IN DIMENSIONS, CHARACTER OR EXTENT OF THE EXISTING FEATURES SHALL BE BROUGHT TO THE ATTENTION OF THE ENGINEER BEFORE ADVANCING THE WORK. SHOP DRAWINGS REQUIRED FOR VARIOUS ITEMS OF THE WORK SHALL INDICATE THE ACTUAL FIELD MEASUREMENTS AND SHALL BE SO NOTED.
- REMOVE TOPSOIL FOR ITS TOTAL DEPTH WITHIN THE LIMITS OF THE SLOPE LINES, UNLESS OTHERWISE DIRECTED, STOCKPILE TOPSOIL AND USE IT ON THIS PROJECT AS NEEDED UNDER SECTION 646.
- THE CONTRACTOR SHALL CONTACT DIGSAFE AT 811 A MINIMUM OF 72 HOURS PRIOR TO ANY EXCAVATION.
- SHOULD ANY ALTERING, ADJUSTING, OR RELOCATING OF UTILITIES BE REQUIRED, THIS WORK SHALL BE COMPLETED BY THE APPROPRIATE UTILITY COMPANY AND IS NOT PART OF THIS CONTRACT. HOWEVER, THE CONTRACTOR SHALL FACILITATE THE UTILITY COMPANY IN THEIR PERFORMANCE OF THIS WORK.
- ANY DITCHLINES THAT EXCEED 6 PERCENT IN GRADE SHALL BE LINED WITH RIP-RAP OR TURF REINFORCEMENT MATTING AS SPECIFIED ON THE PLANS.
- ALL SIGNS, MAILBOXES, PROPERTY BOUNDS, ETC. DISTURBED BY THE CONSTRUCTION ACTIVITIES SHALL BE RESET BY THE CONTRACTOR OR HIS AGENT.
- CONTRACTOR SHALL COORDINATE WITH THE FIELD ENGINEER AND REMOVE TREES AS NECESSARY TO COMPLETE THE WORK AND/OR AS DIRECTED BY THE TOWN ENGINEER.
- CONSTRUCT PAVED DRIVE APRONS FOR ALL EXISTING DRIVEWAYS AS DIRECTED.
- ALL NEW EMBANKMENT SLOPES SHALL BE LOAMED AND SEEDED. MULCH AS DIRECTED.
- CONTRACTOR SHALL ASSUME ALL RESPONSIBILITY FOR TRAFFIC CONTROL AND ASSOCIATED SIGNAGE AND WARNING DEVICES DURING EXECUTION OF THIS CONTRACT.
- GROUND SURVEY AND BASE PLAN PROVIDED BY SANDFORD SURVEYING AND ENGINEERING, INC., BEDFORD, NH.
- TYPICAL SECTIONS AND DETAILS PROVIDED BY TOWN OF BEDFORD, NH.
- EXPOSED SOILS IN DELINEATED WETLANDS AT OUTFALLS AND ALONG SWALES WILL BE SEEDED WITH ERNMX-183, NATIVE DETENTION AREA SEED MIX, OR EQUIVALENT.

1 STA 14+05.0, RT 20.0' TO STA 14+00.0, LT 20.0'  
 CONSTRUCT 40 FT X 48 IN RCP, 3750D  
 48 IN INV. @ INLET = 175.85  
 48 IN INV. @ OUTLET = 175.80  
 CONSTRUCT MORTAR RUBBLE MASONRY HEADWALL @ INLET AND OUTLET

| CURVE TABLE |              |             |         |        |        |
|-------------|--------------|-------------|---------|--------|--------|
| CURVE #     | PI           | Δ           | R       | T      | L      |
| CURVE 1     | STA 13+35.14 | 23° 00' 49" | 1150.00 | 234.11 | 461.91 |

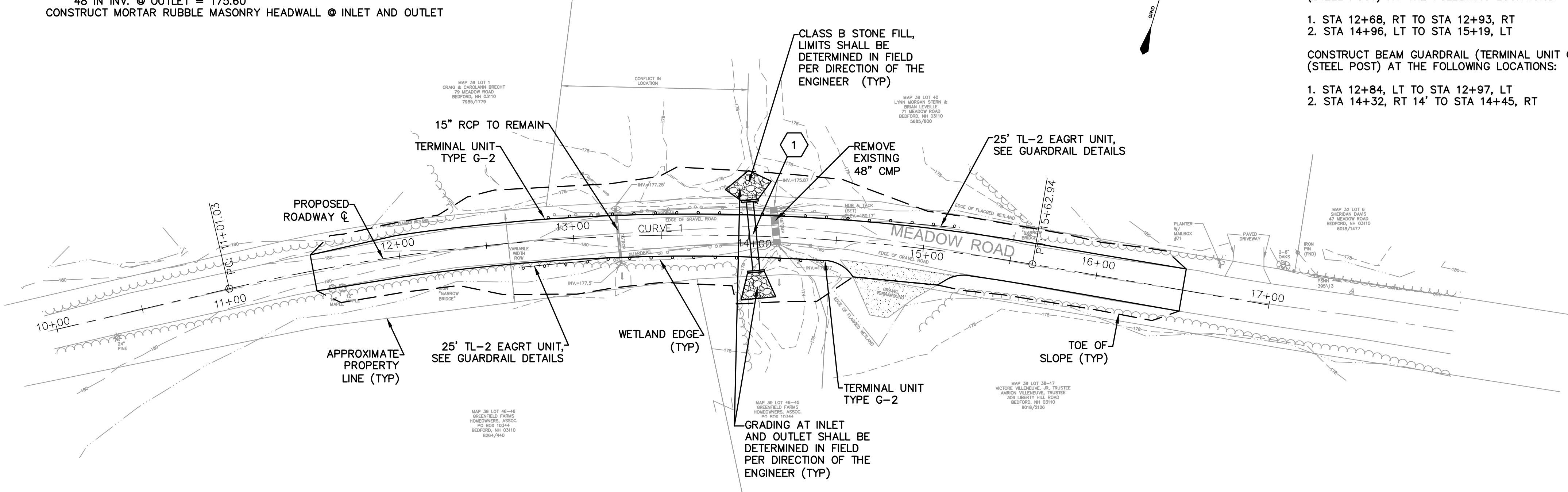

**GUARDRAIL NOTES**

- REMOVE GUARDRAIL AT THE FOLLOWING LOCATIONS:
- STA 12+89, LT TO STA 14+37, LT
  - STA 13+23, RT TO STA 14+36, RT
- CONSTRUCT BEAM GUARDRAIL (STANDARD SECTION - STEEL POSTS) AT THE FOLLOWING LOCATIONS:
- STA 12+97, LT TO STA 14+96, LT
  - STA 12+93, RT TO STA 14+32, RT
- CONSTRUCT BEAM GUARDRAIL (TERMINAL UNIT EAGRT25) (STEEL POST) AT THE FOLLOWING LOCATIONS:
- STA 12+68, RT TO STA 12+93, RT
  - STA 14+96, LT TO STA 15+19, LT
- CONSTRUCT BEAM GUARDRAIL (TERMINAL UNIT G-2) (STEEL POST) AT THE FOLLOWING LOCATIONS:
- STA 12+84, LT TO STA 12+97, LT
  - STA 14+32, RT 14' TO STA 14+45, RT

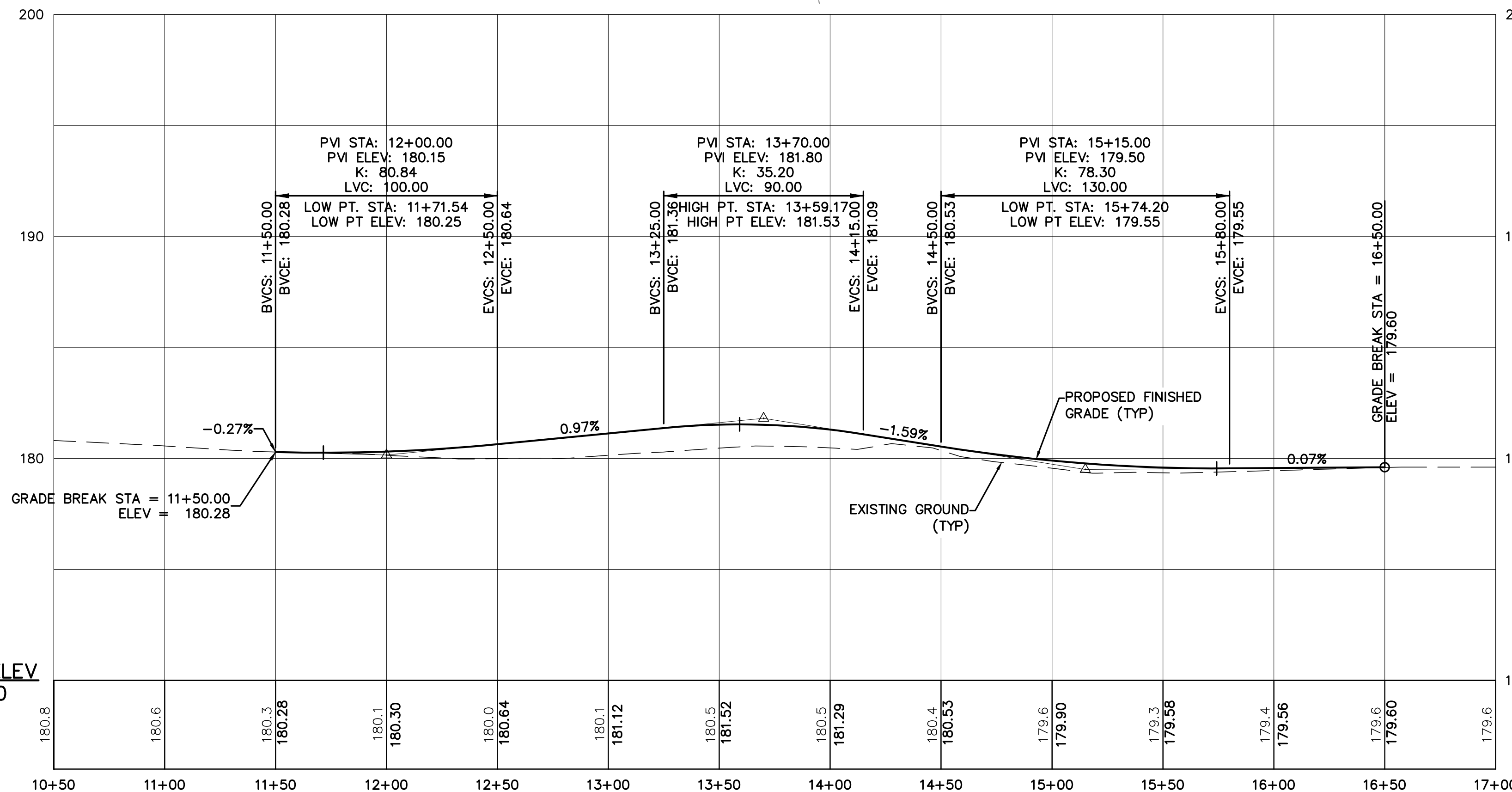

DATUM ELEV  
170.00

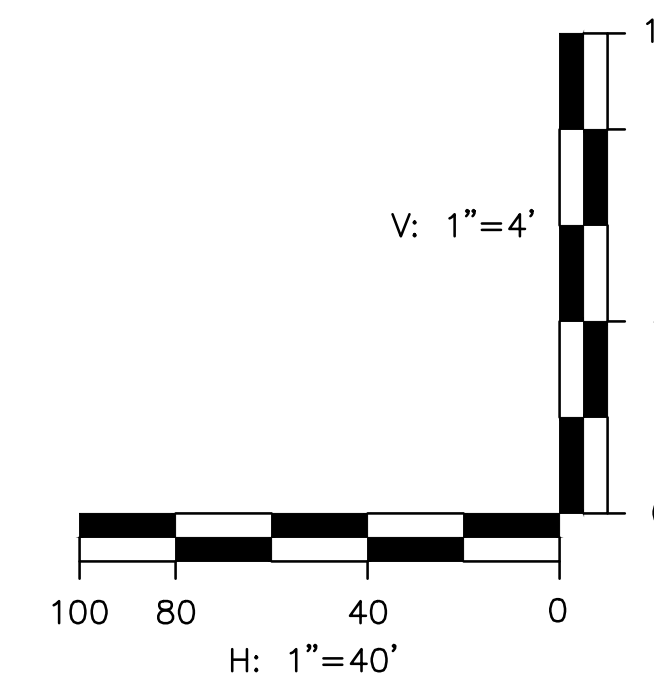

**MEADOW ROAD PLAN AND PROFILE**

PREPARED FOR:  
**TOWN OF BEDFORD**  
 24 NORTH AMHERST ROAD  
 BEDFORD, NEW HAMPSHIRE 03110

**MEADOW ROAD CULVERT REPLACEMENT**  
 BEDFORD, NEW HAMPSHIRE

| NO. | DATE | REVISION DESCRIPTION |
|-----|------|----------------------|
|     |      |                      |

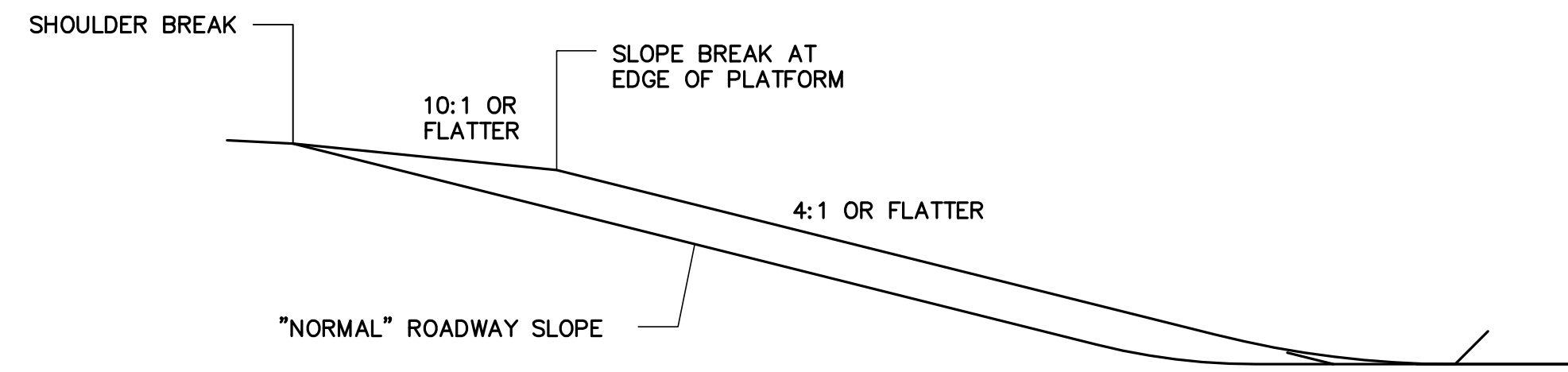

SECTION A-A  
PLATFORM SLOPE GRADING

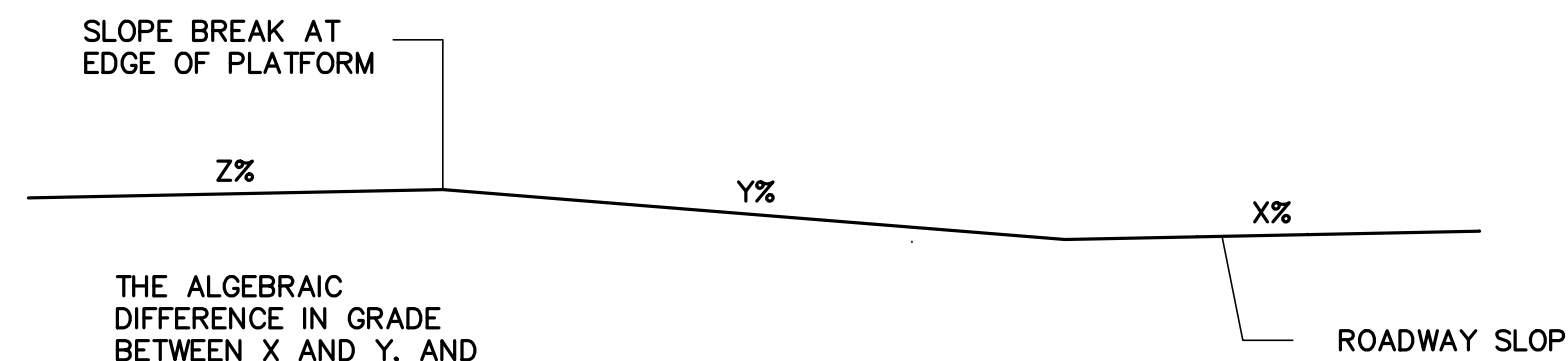

SECTION B-B  
PLATFORM APPROACH GRADING

X: LONGITUDINAL GRADE OF ROADWAY SLOPE IN ADVANCE OF PLATFORM  
Y: LONGITUDINAL GRADE OF PLATFORM APPROACH  
Z: LONGITUDINAL GRADE OF PLATFORM

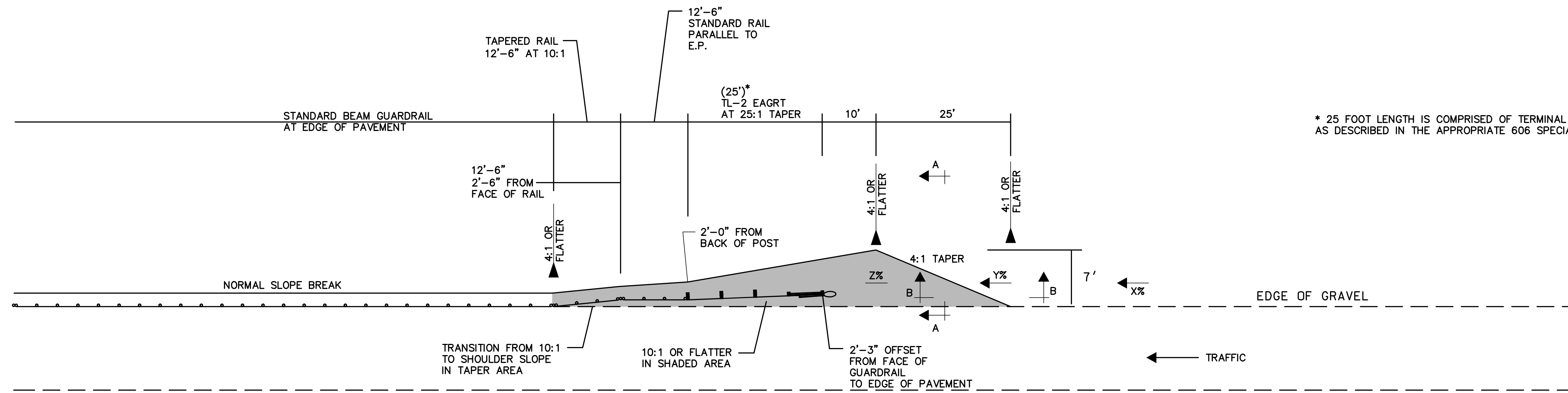

25' TL-2 EAGRT UNIT

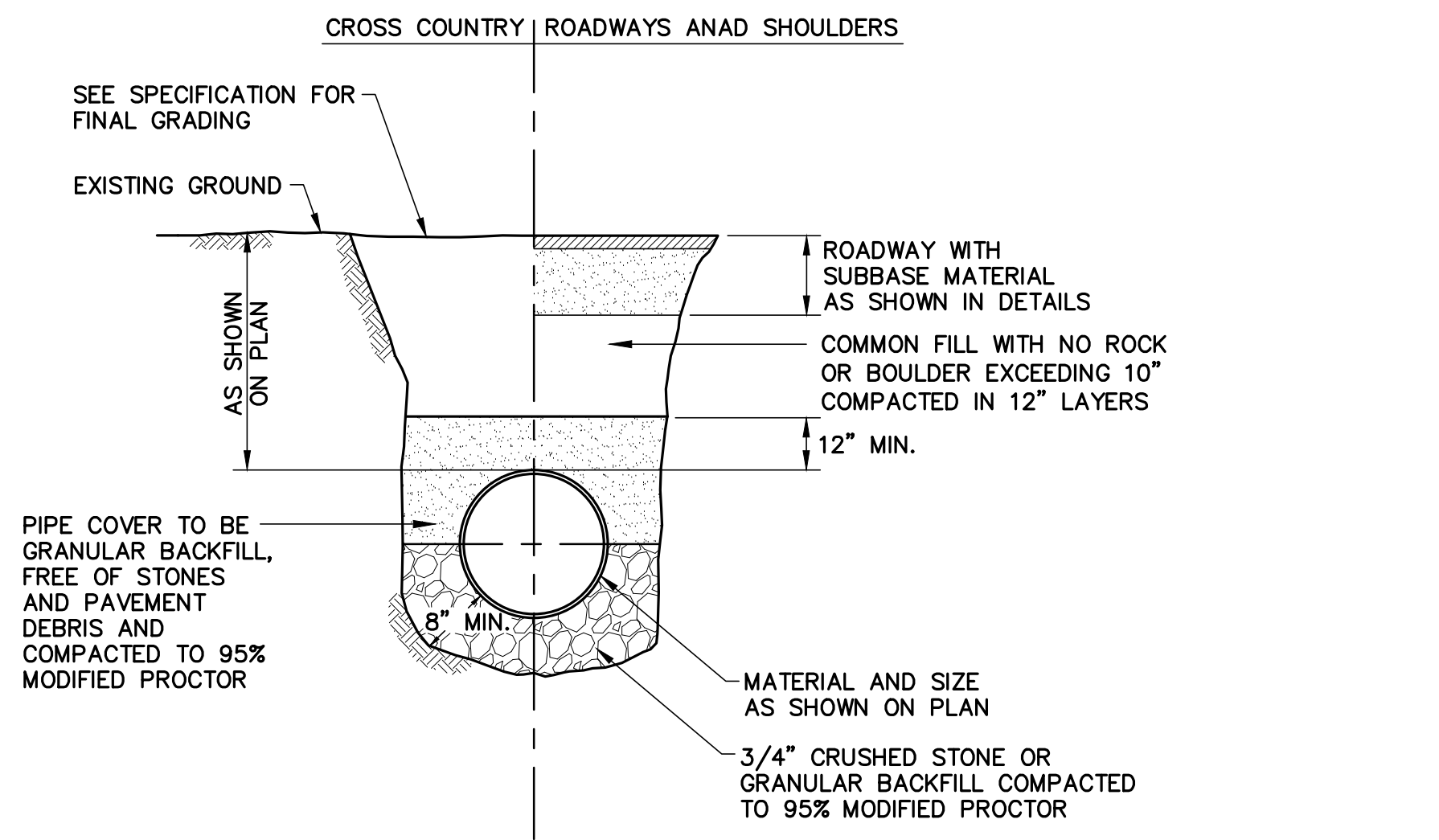

**DRAIN PIPE TRENCH**  
NOT TO SCALE

NOTES:  
1. ALL EXCAVATION AND BACKFILL FOR TRENCH TO BE SUBSIDIARY TO PIPE CONSTRUCTION PAY ITEM PER TOWN OF BEDFORD SPECIFICATIONS.

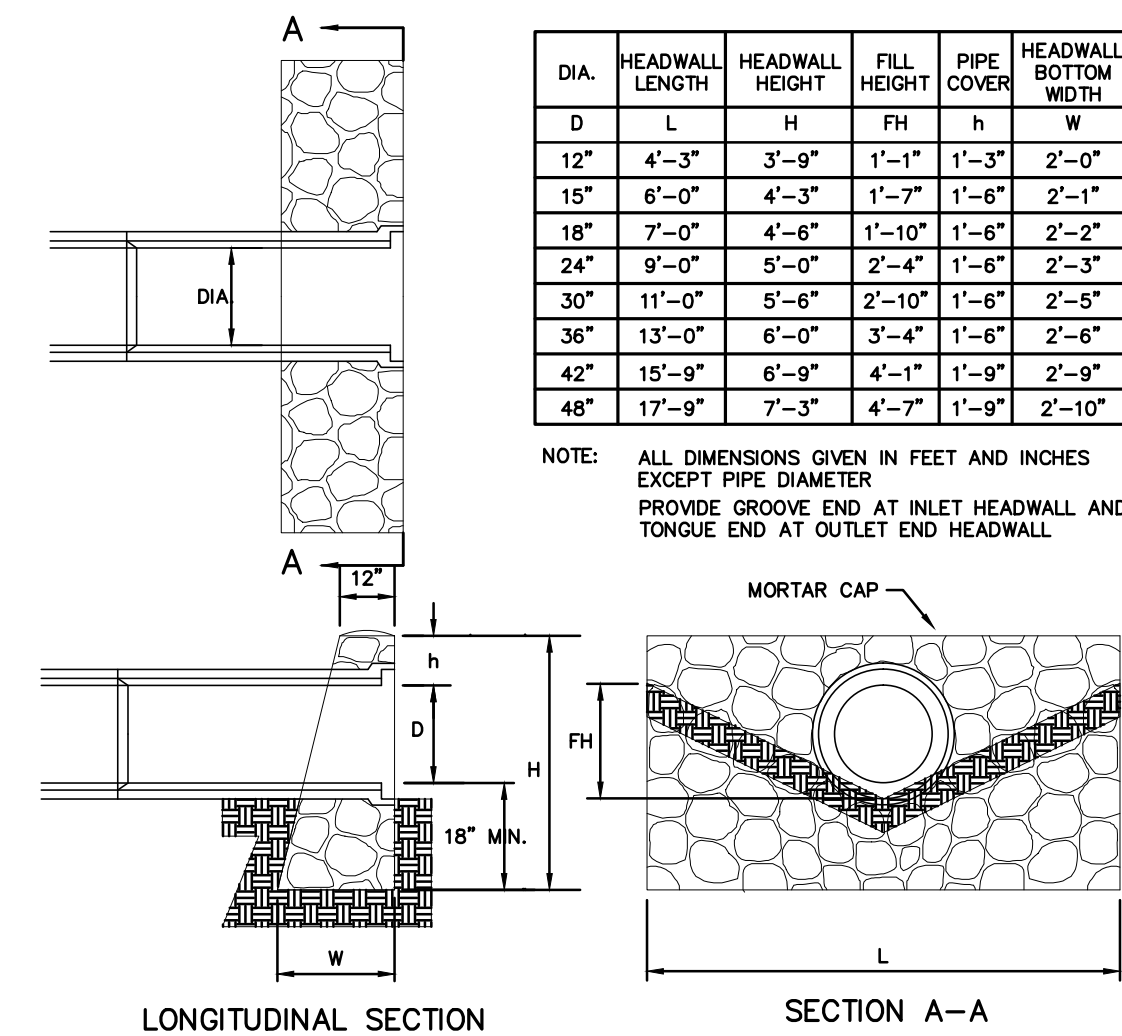

**MORTAR RUBBLE MASONRY HEADWALL DETAIL**  
NOT TO SCALE

| DIA. | HEADWALL LENGTH | HEADWALL HEIGHT | FILL HEIGHT | PIPE COVER | HEADWALL BOTTOM WIDTH |
|------|-----------------|-----------------|-------------|------------|-----------------------|
| D    | L               | H               | FH          | h          | W                     |
| 12"  | 4'-3"           | 3'-9"           | 1'-1"       | 1'-3"      | 2'-0"                 |
| 15"  | 6'-0"           | 4'-3"           | 1'-7"       | 1'-6"      | 2'-1"                 |
| 18"  | 7'-0"           | 4'-6"           | 1'-10"      | 1'-6"      | 2'-2"                 |
| 24"  | 9'-0"           | 5'-0"           | 2'-4"       | 1'-6"      | 2'-3"                 |
| 30"  | 11'-0"          | 5'-6"           | 2'-10"      | 1'-6"      | 2'-5"                 |
| 36"  | 13'-0"          | 6'-0"           | 3'-4"       | 1'-6"      | 2'-6"                 |
| 42"  | 15'-9"          | 6'-9"           | 4'-1"       | 1'-9"      | 2'-9"                 |
| 48"  | 17'-9"          | 7'-3"           | 4'-7"       | 1'-9"      | 2'-10"                |

NOTE: ALL DIMENSIONS GIVEN IN FEET AND INCHES EXCEPT PIPE DIAMETER. PROVIDE GROOVE END AT INLET HEADWALL AND TONGUE END AT OUTLET HEADWALL.

| NO. | DATE | REVISION DESCRIPTION |
|-----|------|----------------------|
|     |      |                      |

MISCELLANEOUS  
DETAILS

PREPARED FOR:  
**TOWN OF BEDFORD**  
24 NORTH AMHERST ROAD  
BEDFORD, NEW HAMPSHIRE 03110

**MEADOW ROAD CULVERT REPLACEMENT**  
BEDFORD, NEW HAMPSHIRE

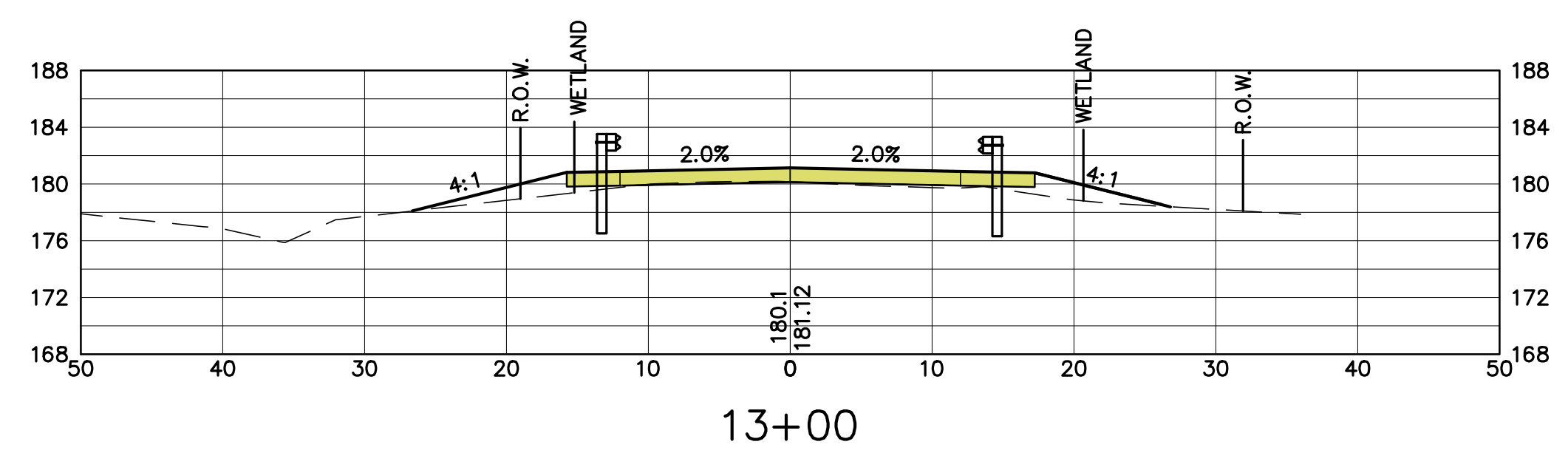

13+00

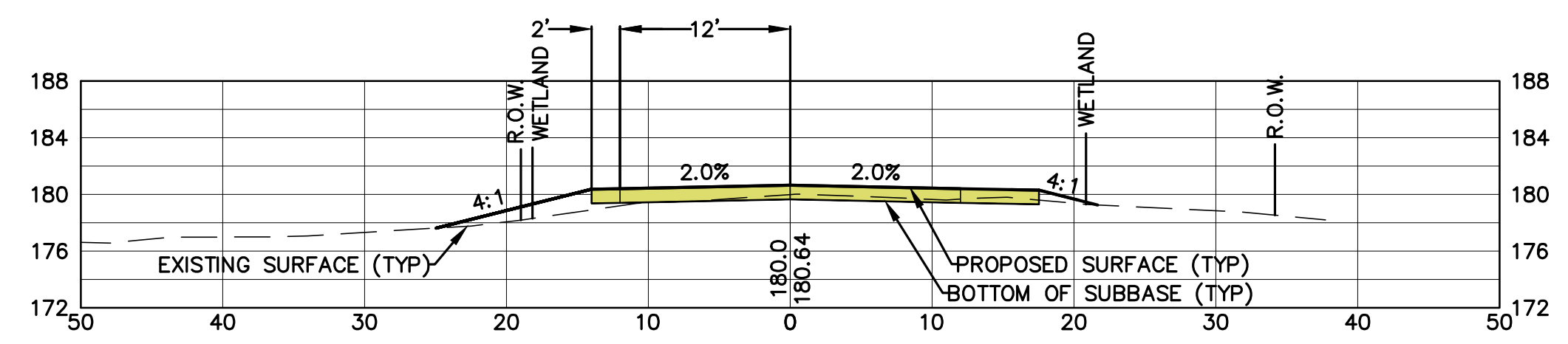

12+50

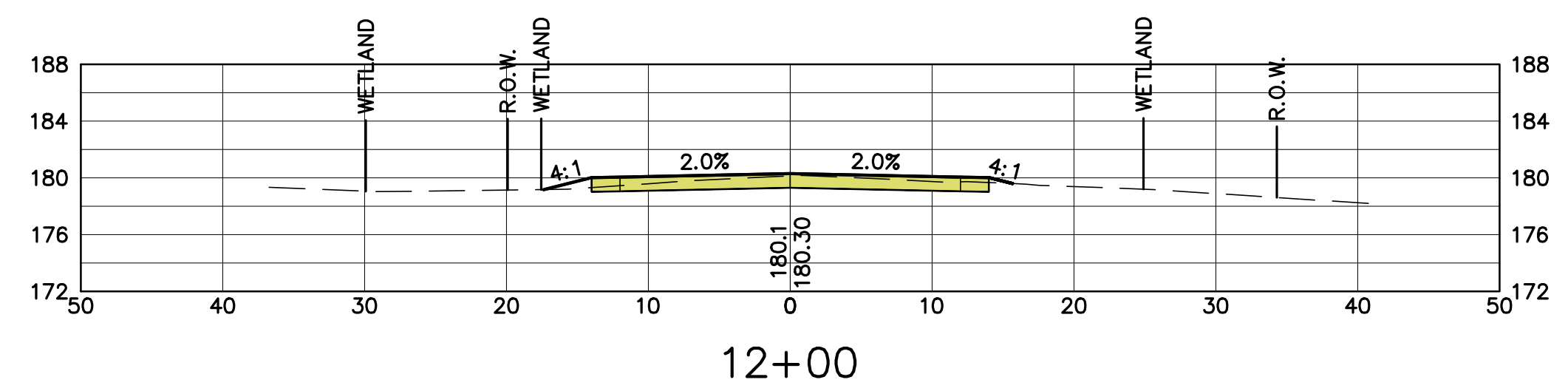

12+00

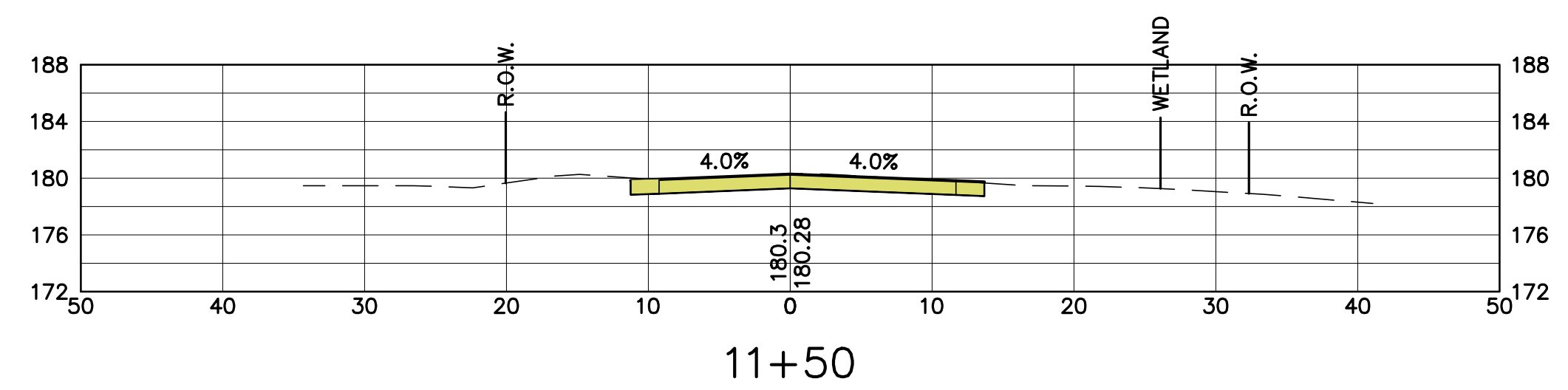

11+50

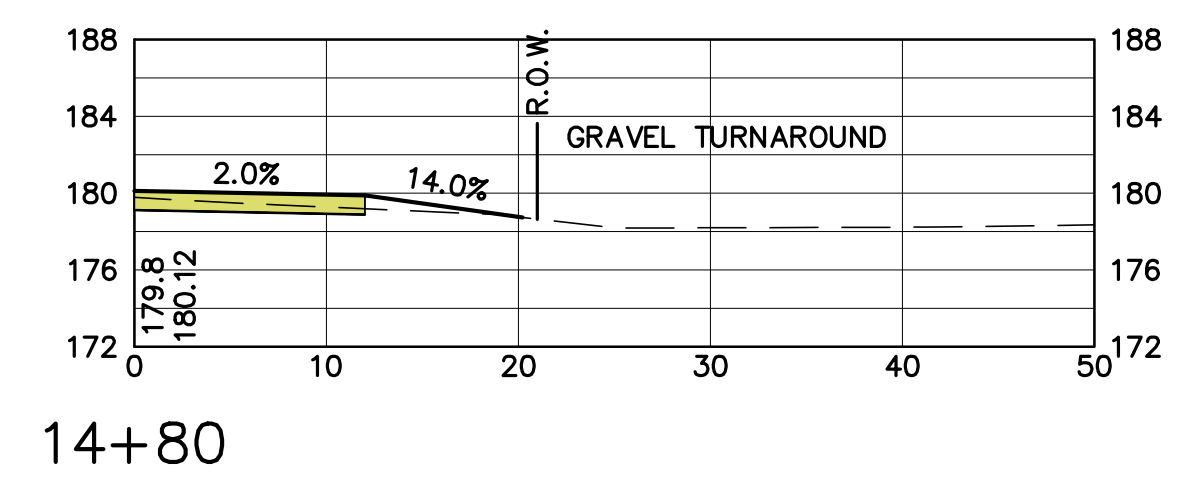

14+80

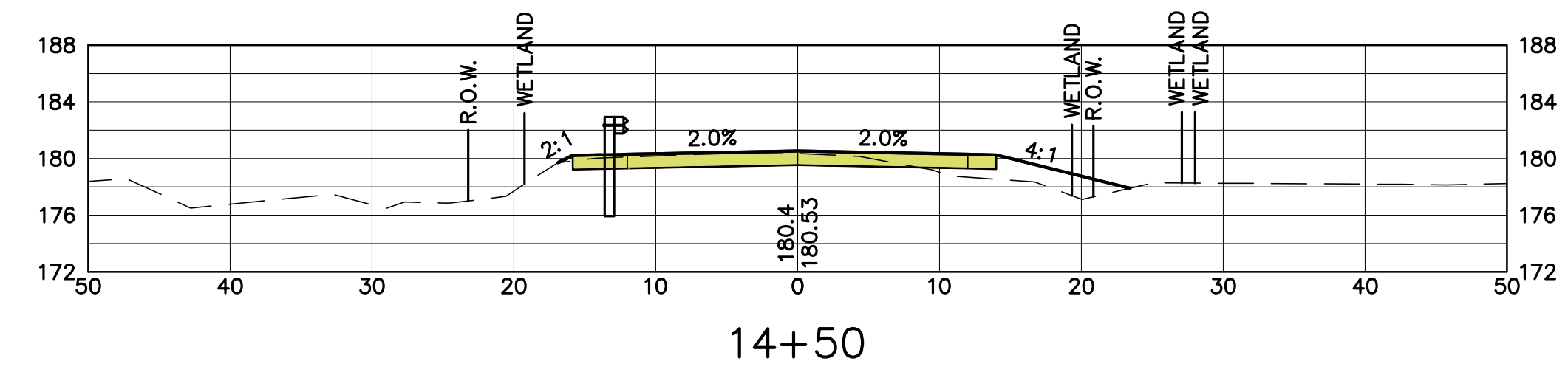

14+50

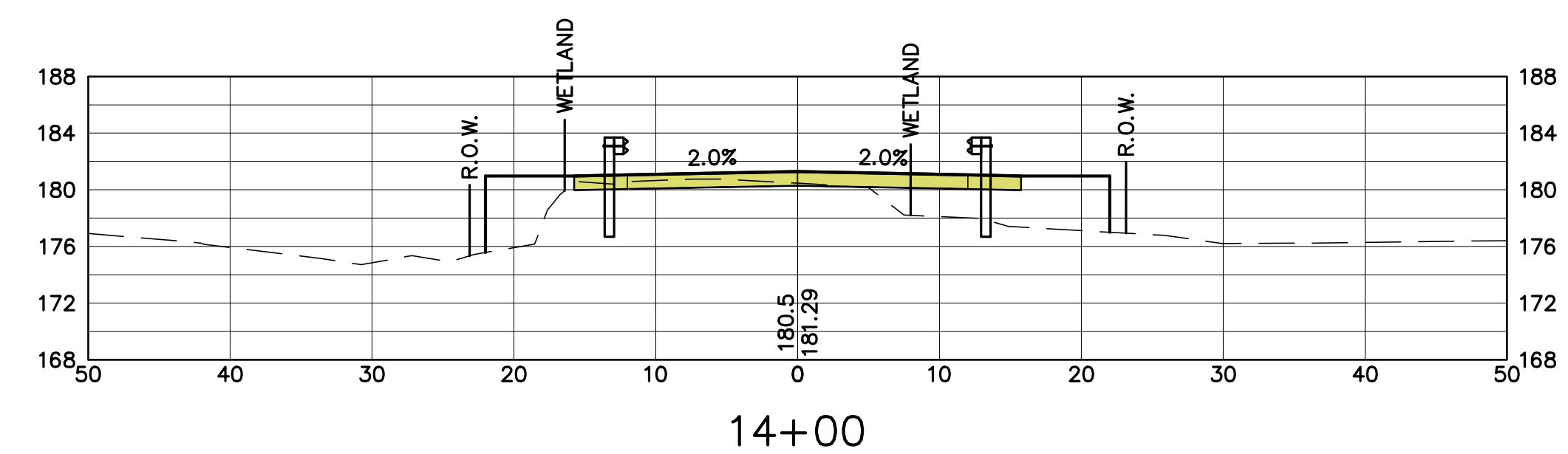

14+00

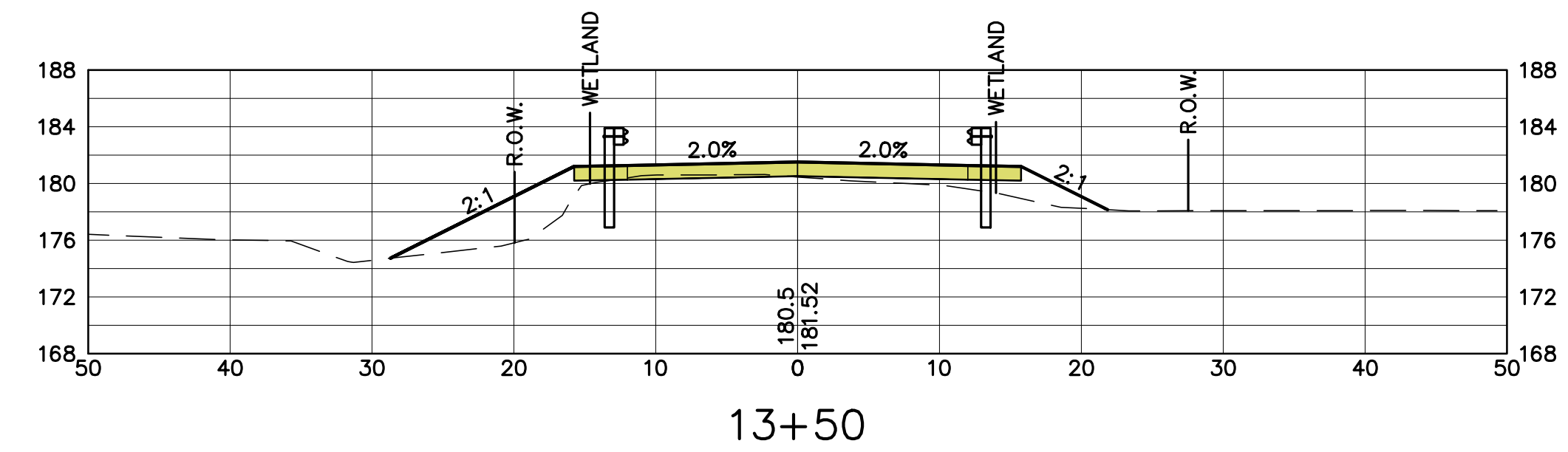

13+50

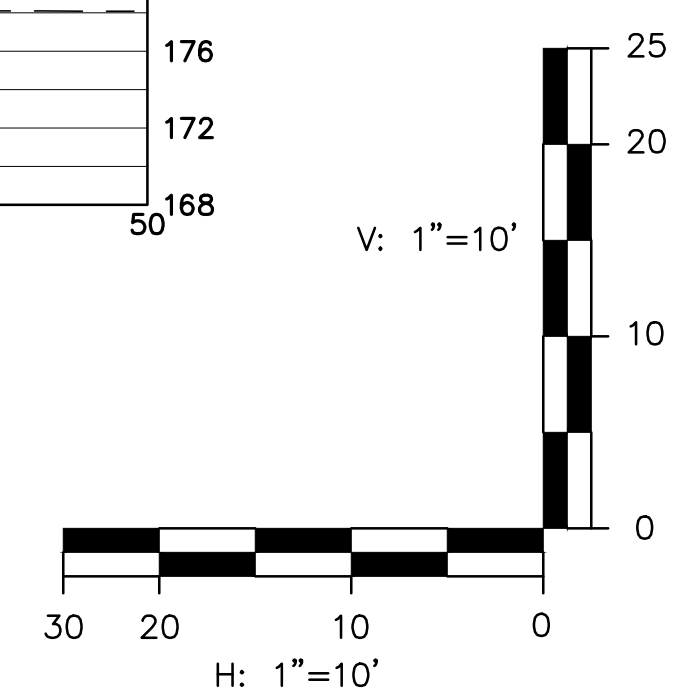

|   |   |   |  |                      |
|---|---|---|--|----------------------|
| <p>MEADOW ROAD CULVERT REPLACEMENT<br/>BEDFORD, NEW HAMPSHIRE</p> | <p>PREPARED FOR:<br/>TOWN OF BEDFORD<br/>24 NORTH AMHERST ROAD<br/>BEDFORD, NEW HAMPSHIRE 03110</p> | <p>DATE: DECEMBER 10, 2015    PROJ. 99-2015</p> | NO.  | REVISION DESCRIPTION |
|   |   |   | DATE   | NO.                  |
|   |   |   | <p>MEADOW ROAD<br/>CROSS SECTIONS<br/>11+50 TO 14+80</p> |                      |
|   |   |   | SHEET: 3   | OF 4                 |

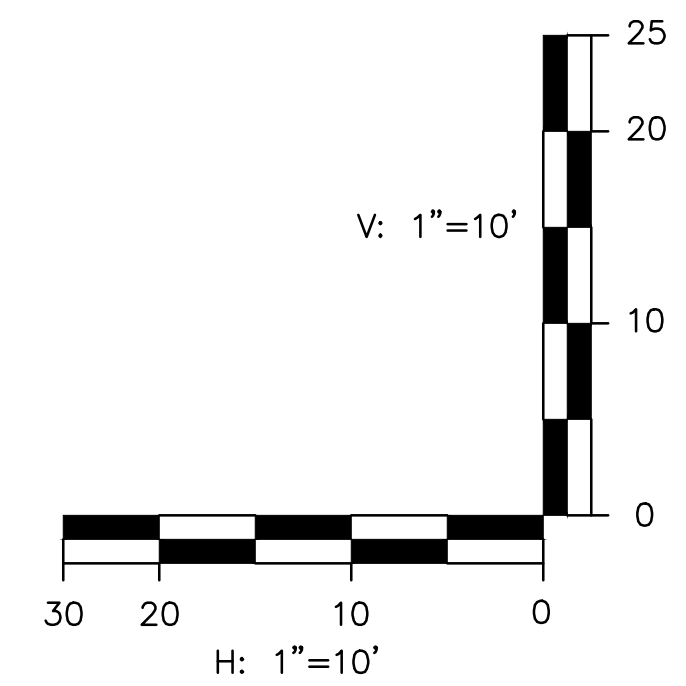
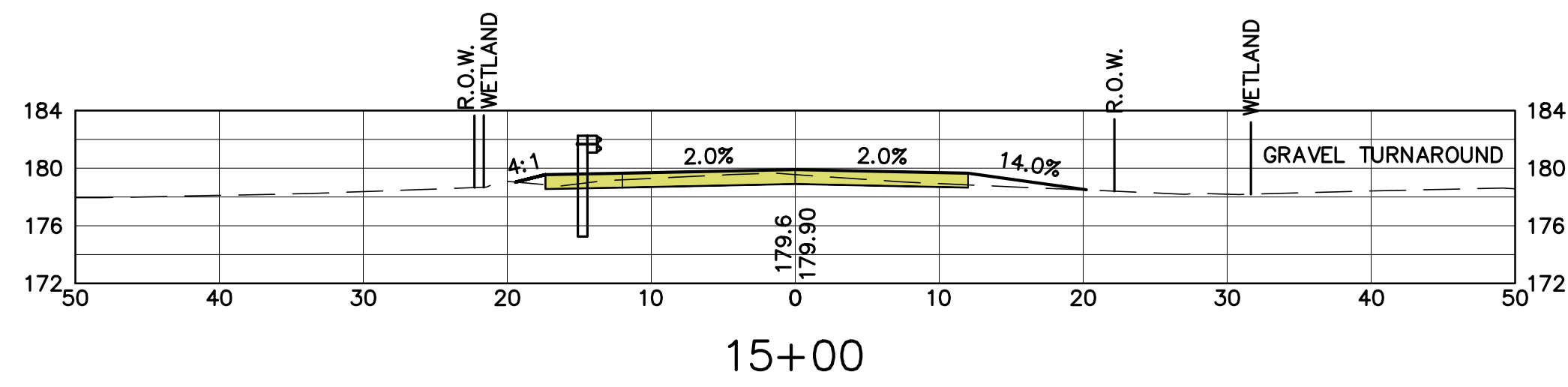
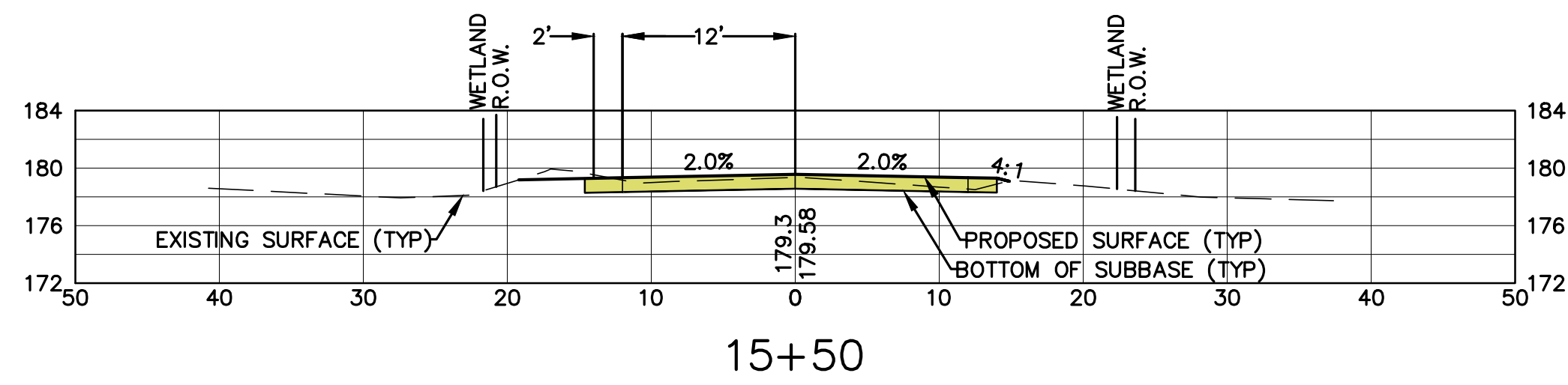
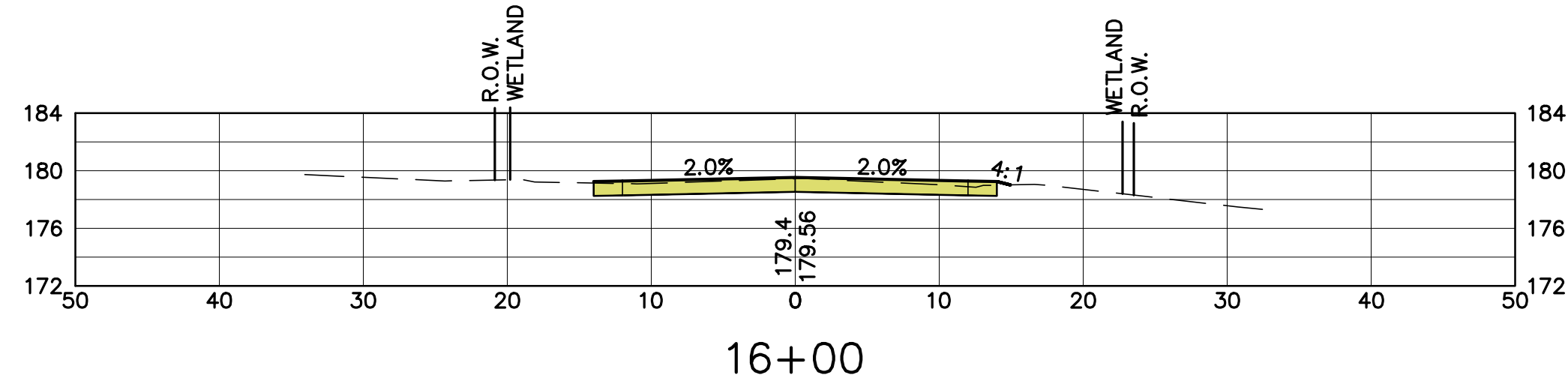
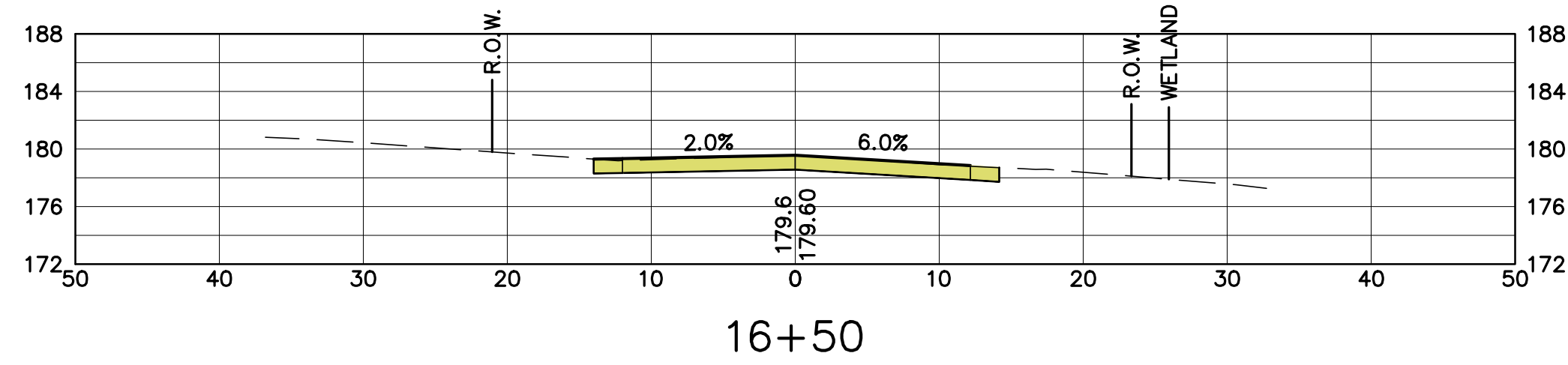

|   |   |   |  |     |      |                      |
|---|---|---|--|-----|------|----------------------|
| <p>MEADOW ROAD CULVERT REPLACEMENT<br/>BEDFORD, NEW HAMPSHIRE</p> | <p>PREPARED FOR:<br/>TOWN OF BEDFORD<br/>24 NORTH AMHERST ROAD<br/>BEDFORD, NEW HAMPSHIRE 03110</p> | <p>DATE: DECEMBER 10, 2015    PROJ. 99-2015</p> | <p>MEADOW ROAD<br/>CROSS SECTIONS<br/>15+00 TO 16+50</p> | NO. | DATE | REVISION DESCRIPTION |
|   |   |   |  |     |      |                      |
|   |   |   |  |     |      |                      |
|   |   |   |  |     |      |                      |