



McCONAGHY
Classics

Intro

We are pleased to announce the release of our new 49ft Pilot Cutter. The yacht combines the classic styling of Hoek Design, with the benefits of a performance cruising yacht. Constructed with some of the world's most advanced production methods and materials, this yacht will be built in semi-production, but allow a level of customisation and owner involvement to ensure every yacht is unique.

The yachts will be built at McConaghy's facilities near Hong Kong, the same facilities that build many of the world's leading race yachts.

Hoek Design hallmarks are evident including attractive sheer, an open bulwark, a counter stern and low profile superstructure. Hoek Design has optimised the hull for fast cruising with a modern keel fin and bulb. In addition, the boat will feature optimised foils to bring an extra element of performance.

The yacht will be outfitted with a carbon rig and a sailplan with self-tacking jibs for ease of handling. The interior is classic styling with modern equipment and outfitting.

All joinery is built and finished to McConaghy's high-quality standards. The interior is constructed using a mix of painted surfaces with timber laminate and soft fabric liners, and can be tailored to the client's requirements.

We look forward to working with you.

Regards



Mark Evans
Managing Director



Rodney Martin
Sales



McCONAGHY
Pilot Cutter 49

HOEK DESIGN
NAVAL ARCHITECTS



McCONAGHY
Pilot Cutter 49

HOEK DESIGN
NAVAL ARCHITECTS

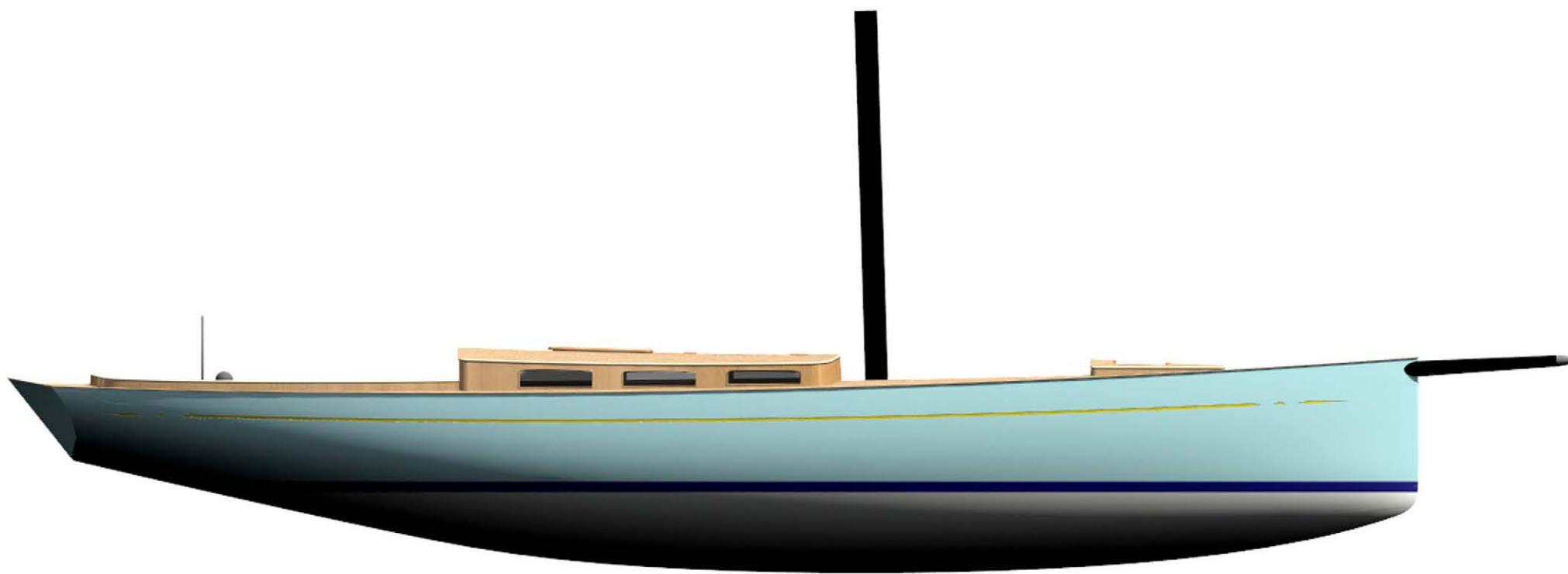

McCONAGHY
Pilot Cutter 49

HOEK DESIGN
NAVAL ARCHITECTS

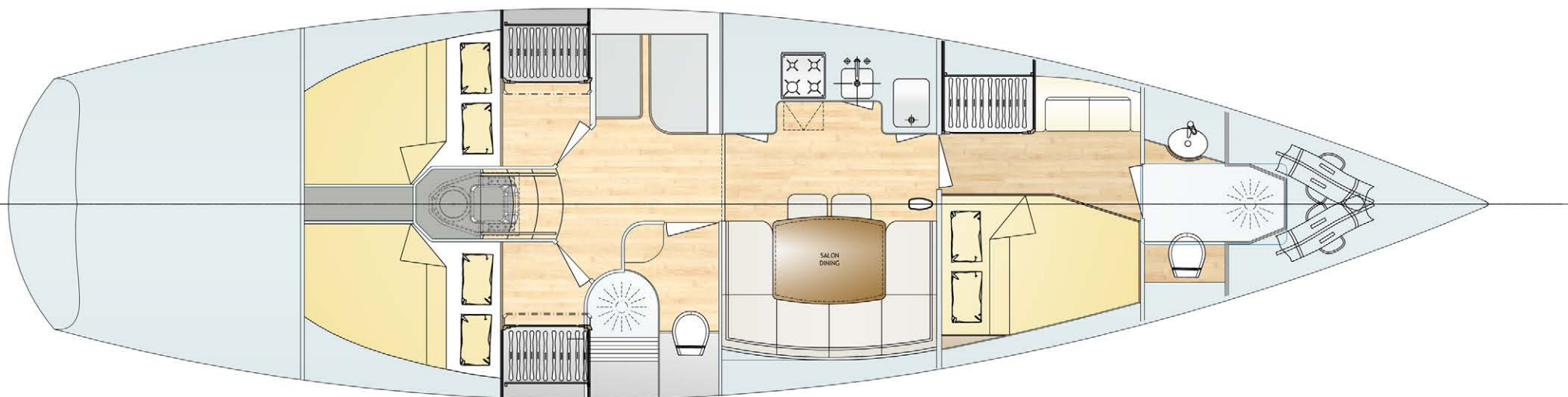

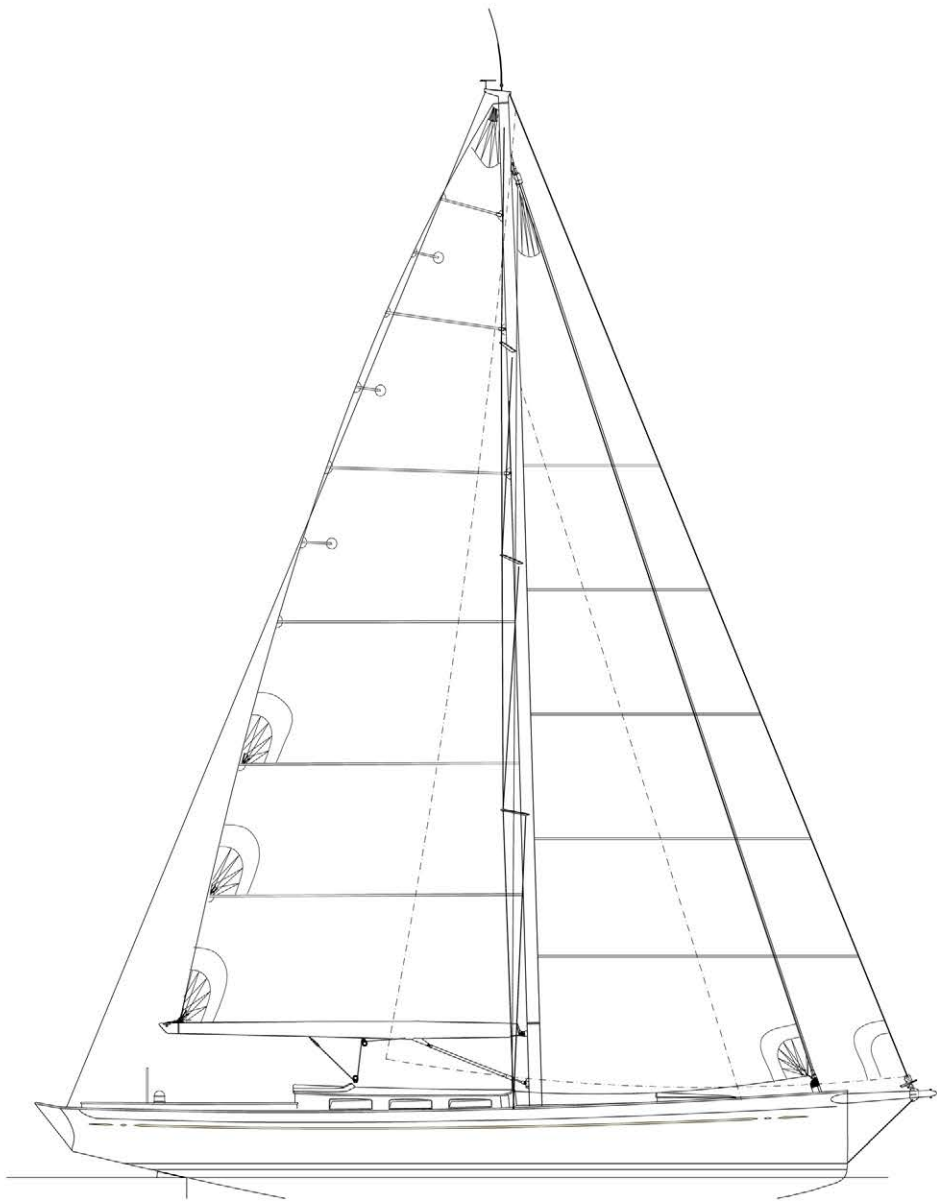
General Specification

Main Dimensions:

LHull 14.95m

BHull 3.95m

LWL 11.95m

Draught Keel 2.8m

Displacement half load (approximate) 13.5T

Sail Dimensions:

P 16.9m

E 6.4m

I 17.5m

J 5.1m

Mainsail 63m²

Jib 48m²

Code 0 95m²

Spinnaker 150m²

Mast Data for full load:

Spreader Angle 18deg

Half CPW 1.6m

Naval Architect

Hoek Design

Hoek Design

Dating back to 1987, the Hoek range of classic yachts consists of custom-designed and custom-built projects developed in close partnership with owners. Ranging in size from 33 to 262 feet, these sloops, schooners and ketches all have their own distinctive interiors, sail plans and layouts.

What all Hoek classics have in common is the way they combine a classic hull shape and above-water styling with a modern under-water configuration. The first designs with a wing keel and spade rudder were the 70-foot sloop Joss and the 70-foot ketch Kim; their unprecedented performance and manoeuvrability were seen as a true breakthrough in yachting.

Hoek Design became the frontrunner in the 'classic above/modern below' approach to yachting. And, as shown by designs such as the 37 feet Wallynano and Athos (203 feet), a broad range and an ongoing commitment to perfection enable Holland-based Hoek Design to maintain a leading position to this day.

"When I visited the McConaghy yard in 2015, I was very impressed by the quality of their composite work and experience in series production and robot systems.

We then immediately initiated discussions on a range of hi-tech composite production yachts starting around 60 feet with an aim to develop Composite Superyachts as well. We are delighted to work together on these special craft with an experienced team of people on both sides of the globe and being able to serve both the European and Asian markets."

- Andre Hoek



McConaghy Quality & Corporate Strength

Our Mission: Create the best composite shop on the planet and bring the overwhelming advantages of composites to a wide range of applications with cost effectiveness, high quality, precision, and innovation in materials, design, prototyping, production runs, and custom work. With facilities in Sydney, Australia and China, McConaghy uses a combination of the latest technology and generations of expertise to provide solutions to problems that challenge convention in other industries.

The McConaghy Assurance Program (MAP) is an organisational quality and effectiveness initiative that powerfully aligns our people, processes and physical factory with our purpose of being the best composite factory on the planet. McConaghy's workforce operates to a "6S" quality system on the factory floor. The 6S methodology (Sort, Streamline, Shine, Standardise, Sustain, and Safety) represents a common working practice for work station logic and neatness, standardization of process, development of staff, and safety for all involved. We have a single standard smooth process for producing a range of customized (tailor-made) and series products ensuring everything we produce meets or exceeds the agreement with our customer. In addition to production management, our quality system covers everything from contracting to procurement all the way to shipping and after-sales service. The company has continually grown its reputation since McConaghy boats was founded by John McConaghy in 1967. Since then has

expanded to include manufacturing bases in Australia and China, and a design office in New Zealand. McConaghy deploys its wealth of talent across a number of different divisions, extending the strong commercial platform that has allowed it to defy industry trends and continue to thrive even in the toughest economic conditions.

The company was further strengthened in early 2014 with the signing of an investment agreement with Hong Kong based Tiger Group Investments, a prominent commercial marine company led by keen yachtsman Graham Porter. The new partnership with Tiger Group provides capital for further investment in state of the art facilities, machinery and equipment at McConaghy's operations in China and Sydney. McConaghy is privately owned, the group has no debt, and owns all of its equipment. The company currently employs 200+ staff and operates from facilities in Australia, China and New Zealand.



Consistently at the forefront of composite technology

McConaghy were one of the first builders in the world to apply prepreg carbon to sailing boat construction in the mid 1970's. Built from materials previously only used in aerospace applications, the first prepreg carbon 18ft skiff, built by McConaghy, was a revelation and would set a performance benchmark for years to come. Customers and designers were soon demanding this performance in bigger and bigger yachts.

The first prepreg nomex cored maxi yacht was constructed by McConaghy Boats in 1987, engineered by Giovanni Belgrano and SP Systems, this yacht was the largest composite structure in the world at that time, outside of the US Space program.

McConaghy have been researching, testing and perfecting the techniques and processes required to build high strength durable and the lightest weight possible composite structures for over 40 years.

McConaghy have developed and continued to refine techniques for ensuring bonding between honeycomb cores (both Kevlar and Nomex) and carbon skins are robust and reliable. McConaghy have developed techniques for thermoforming Kevlar and nomex honeycomb cores as well as Corecell foams in house, ensuring that engineers can specify the best properties in the most challenging geometry.

Many challenges that other yards are still discovering when using prepregs and nomex material are challenges McConaghy overcame decades ago.

The fact that so many of our successful maxi yachts have performed faultlessly for decades contrasts with the long list of known and lesser known failures in the industry.

Working closely with designers, engineers, material suppliers and leading industry specialists, McConaghy manages the processes and guarantees the outcomes expected from their customers. This ensures that McConaghy yachts are able to meet the requirements of specified resin contents, achieve the designers nominated component weights and geometry tolerances demanded by the world's best designers and structural engineers.

Most of McConaghy's manufacturing techniques are proprietary, and remain in-house, and have been developed through extensive testing programs on numerous projects across both facilities in Australia and China. McConaghy have experience with every moulding method and mould material, which can be adapted and optimised to suit each customer's unique requirements.



McConaghy Experience

Whether it's building the world's fastest racing yachts, a performance luxury yacht, a submarine to explore the Mariana Trench, components for Formula One racing teams, or developing solutions for architects, scientists and defence organisations, McConaghy has a proven track record of delivering on complex composite projects.

McConaghy boats was founded by John McConaghy in 1967, and since then has expanded to include manufacturing bases in Australia and China, and a design office in New Zealand. McConaghy deploys its wealth of talent across a number of different divisions (now including McConaghy Multihulls), extending the strong commercial platform that has allowed it to defy industry trends and continue to thrive even in the toughest economic conditions.

The company was further strengthened in early 2014 with the signing of an investment agreement with Hong Kong based Tiger Group Investments, a prominent commercial marine company led by keen yachtsman Graham Porter. The new partnership with Tiger Group provides capital for further investment in state of the art facilities, machinery and equipment at McConaghy's operations in China and Sydney.

McConaghy is privately owned by Jono Morris, Mark Evans and Tiger Group Investments the group has no debt, and owns all of its equipment. The company currently employs 200+ staff and operates from facilities in Australia, China and New Zealand.





Proven Performance,
class and style from the world's
leading composite manufacturer

McCONAGHY



Singularity

80.4ft Maxi

Built by McConaghy Boats

Designed by Lutra Yacht Design



McConaghy boats, the leading edge in
composite expertise that stands the test of time

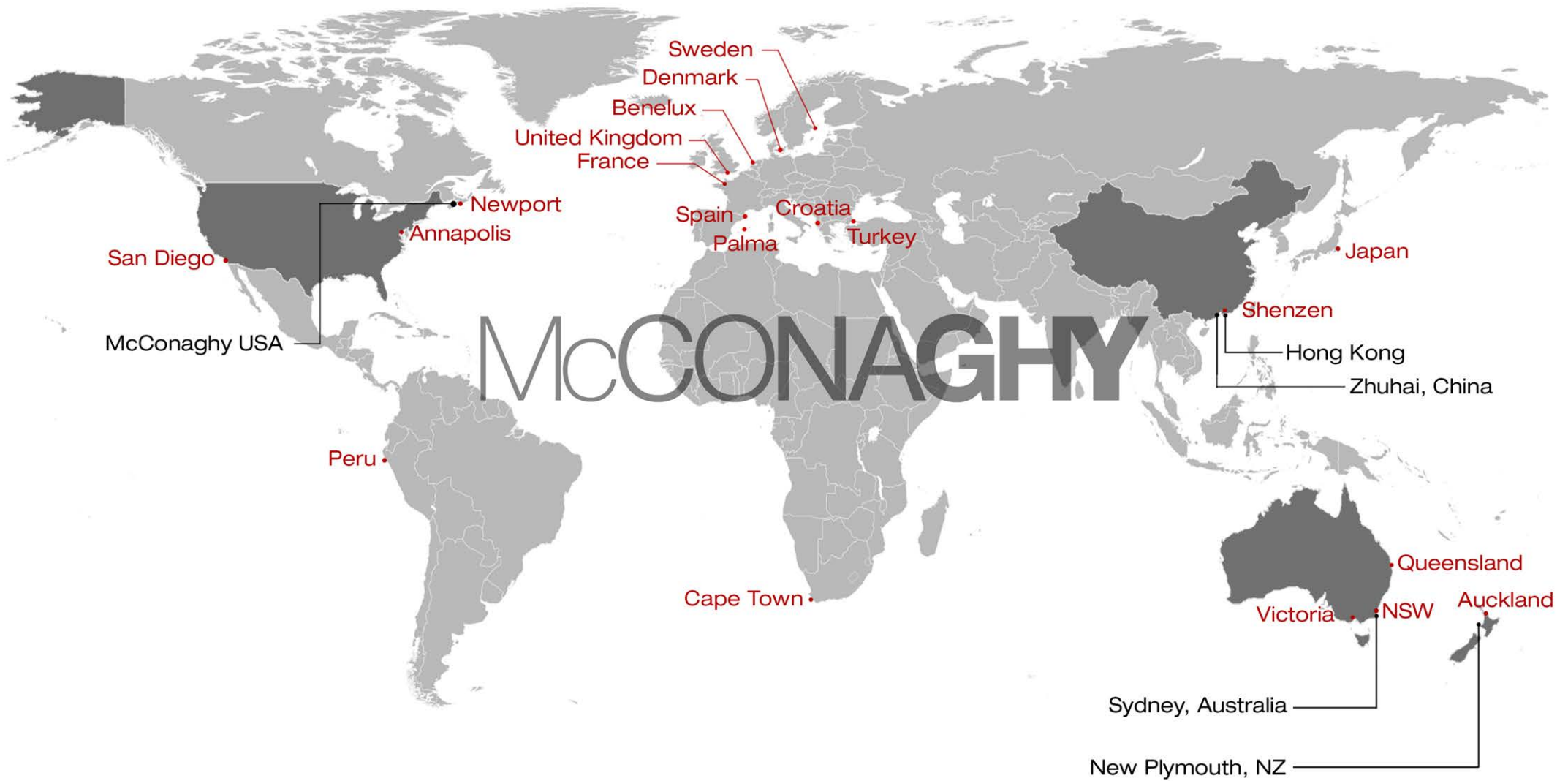

- McConaghy Dealers and Agents
- McConaghy Facilities and Offices

Copyright © 2016 by McConaghy Boats
All Rights Reserved

For all other enquiries please contact :
McConaghy Boats
Rodney Martin
Mobile: +64 27 307 1079
Email: rodney@mcconaghyboats.com

www.mcconaghyboats.com/multihulls

McCONAGHY

The new breed of Classics

www.mcconaghyboats.com