



SURPLUS BULLETIN

## Pullman Private Passenger Car TCRY 106



**\$625,000**

TCRY 106 is a Pullman-Standard 3-compartment 2-drawing room/Observation Lounge which was built in 1925 as Pullman "Central Plains". The car, with its rich history, was later converted to an "official car" and renamed "Shasta" by the Sacramento General Shops on April, 5 1958 for Southern Pacific Transportation Company. On March 19, 1965 SP 106 was renamed "Oregon" where it would finish its life under Southern Pacific as the superintendent's official car for the Oregon Division. The car would later have its interior and exterior refurbished, mechanically overhauled and made Amtrak compliant in Livingston, MT in 1998. The car which is featured in James Kinkaid's SP Color Guide to Freight & Passenger Equipment Volume 3 includes a nicely decorated western themed interior.

Contact: Ken  
Direct - (509)371-8313 x 301  
[surplus@tcry.com](mailto:surplus@tcry.com)





**SURPLUS BULLETIN**

# Pullman Private Passenger Car TCRY 106

## Interior Layout

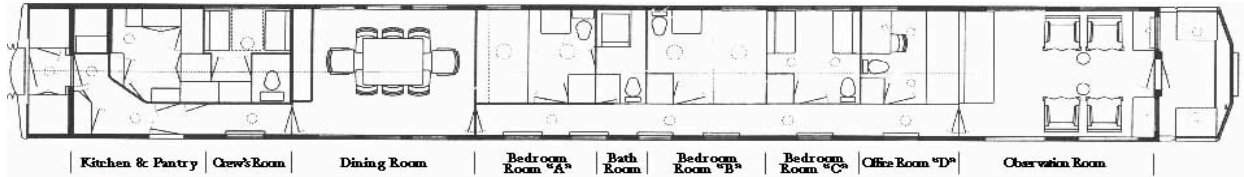

### History

- ❖ Toured U.S. during 1947-1949 American Freedom Train Tour
- ❖ Ridden in by President Truman
- ❖ Carried French Dignitaries during the 1949 Merci Train tour.
- ❖ Featured as rear car on 12/1988 Southern Pacific 4449 Daylight Employee Appreciation Special

### Major Rebuild January 1981 – November 1982

- ❖ Electro-Mechanical Air Conditioning and Electric Heating System
- ❖ Major structural reinforcements added to center sill
- ❖ Car ends rebuilt to correct corrosion
- ❖ Equipped with Microphor Air operated toilet system
- ❖ Fully equipped kitchen converted to all electric
- ❖ 26C air brake system with truck mounted cylinders
- ❖ Interior completely refinished with oak paneling
- ❖ Equipped with 3 fire protection systems
- ❖ 40 Year truck rebuild (performed in 1990).

### Miscellaneous Mechanical Information

- ❖ Amtrak ID No. 800475
- ❖ Amtrak Clearance Code "A" compliant without antenna
- ❖ Amtrak Clearance Code "B" compliant with antenna
- ❖ Amtrak HEP Compliant
- ❖ Max Speed: 90-110 MPH
- ❖ Fully quipped FRA Type II glazing
- ❖ FRA Compliant CFR 49 Part 221 Marker Lights
- ❖ 3 axle trucks equipped with 5-1/2 x 10 Timken Bearings

- ❖ 300 Gallon water capacity
- ❖ Voltage: 220V/480V III Phase with 110V/AC
- ❖ Brakes: Composition Shoes/26C Valves
- ❖ Coupler Type: H Tightlock
- ❖ Vestibule: Only on Platform End

### Amenities

- ❖ Passenger Capacity: 8, Sleeping: 5 plus Crew of 2
- ❖ Open observation platform on B end
- ❖ 3 fully equipped spacious bedrooms
- ❖ Spacious office
- ❖ Equipped with 2 showers
- ❖ Fully furnished
- ❖ Fully equipped kitchen
- ❖ Heating and Air
- ❖ Fully functional water system
- ❖ Music and TV system
- ❖ Telephone outlets

### Car Air Conditioning and Heating System

This railcar is equipped with an easy to run fully automatic heating and air conditioning system. The system requires no manual seasonal changeover to winter/summer operations.

### Electrical system

TCRY 106 is equipped with the following electrical power systems.

1. 480 volt 60 KW Northern Lights Diesel Generator Model NL 488k2.1
2. 480 volt 150 amp Amtrak Trainline
3. 240 volt 100 amp Standby Power
4. 120 volt 6 KW Onan Emergency Generator
5. 120 volt 40 amp Emergency External Plug located on 2 sides.

Contact: Ken  
Direct - (509)371-8313 x 301  
[surplus@tcry.com](mailto:surplus@tcry.com)