

AromaSense

MAKING SENSE OF ESSENTIAL OILS

How to install AromaSense:

1. Install Airtable on your devices using this link to get Airtable:
<https://airtable.com/invite/PMnR8G3w>
This step is only important if you want to use AromaSense on Smart devices (Android and Apple devices)

BASIC VERSION SETUP

1. You will want to perform these steps from your desktop or laptop. After this, you can use AromaSense from any device at any time.
In your *AromaSense Basic version Purchase Info* email you will have received a **password** for the Basic version page of the web site.

Click the link for [AromaSense BASIC on the website and use the password to login.](#)

2. You can use AromaSense from the website, or use the “View larger version” button at the lower right corner (Figure 1A). This will open Airtable with AromaSense in a new tab.

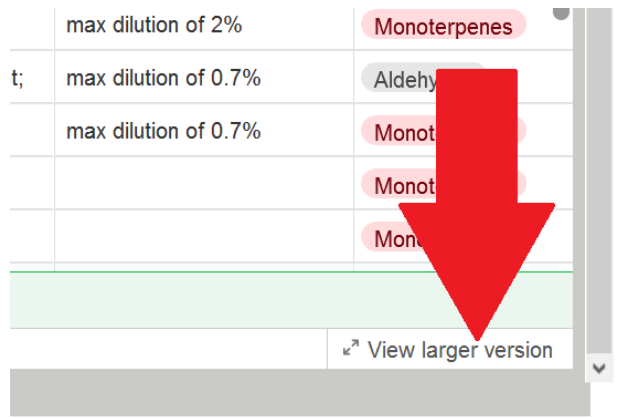

Figure 1A

On a smart device you will be asked if you want to open Airtable, which is the native environment for AromaSense. This is the preferred method since this will automatically add AromaSense to your Airtable icon on your Smart Devices.

Remember that on your SmartDevices, open Airtable to find AromaSense.

FULL VERSION SETUP

- You will want to perform these steps from your desktop or laptop. After this, you can use AromaSense from any device at any time.
In your *AromaSense FULL version Purchase Info* email you will have received a **password** for the FULL version page of the web site.

Click the link for [AromaSense FULL on the website and use the password to login](#).

- First thing look for the “Copy base” button and click the button-



The Copy base button is located either in the top right corner of the screen or on the lower right corner (figure 1B and figure 1C)

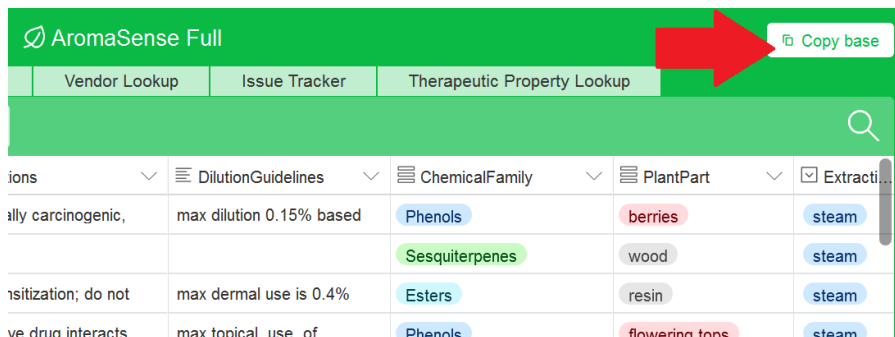

The screenshot shows the AromaSense Full interface. At the top, there is a green header with the logo and the text 'AromaSense Full'. Below the header, there are three tabs: 'Vendor Lookup', 'Issue Tracker', and 'Therapeutic Property Lookup'. In the top right corner of the interface, there is a 'Copy base' button with a document icon. A red arrow points to this button. Below the tabs, there is a search bar and a table of data. The table has columns for 'DilutionGuidelines', 'ChemicalFamily', 'PlantPart', and 'ExtractionMethod'. The data rows show various chemical families and plant parts with their corresponding extraction methods.

	DilutionGuidelines	ChemicalFamily	PlantPart	ExtractionMethod
ions				<input checked="" type="checkbox"/>
ally carcinogenic,	max dilution 0.15% based	Phenols	berries	steam
		Sesquiterpenes	wood	steam
rsitization; do not	max dermal use is 0.4%	Esters	resin	steam
ve drug interacts	max topical use of	Phenols	flowering tops	steam

Figure 1B

Apply sort	☰	☰	☰	☰
safe ...	Cautions	DilutionGuidelines	ChemicalFamily	
	potentially carcinogenic,	max dilution 0.15% based	Phenols	
			Sesquiterpenes	
	skin sensitization; do not	max dermal use is 0.4%	Esters	
	May have drug interacts	max topical use of	Phenols	
	Use topically at a maximum	max dilution of 3.3%	Monoterpenols	
	store in refrigerator;	0.4% when not using	Esters	Monoterp
	drug interaction; drugs		Sesquiterpenes	
	Do not diffuse near or		Oxides	Monoterp
	Do not diffuse near or		Oxides	Esters
	do not use if pregnant or		Sesquiterpenes	
	Possible skin sensitization;		Aldehydes	



Copy base View larger version

Figure 1C

Clicking the “Copy base” button will open the “New Template” dialog box.

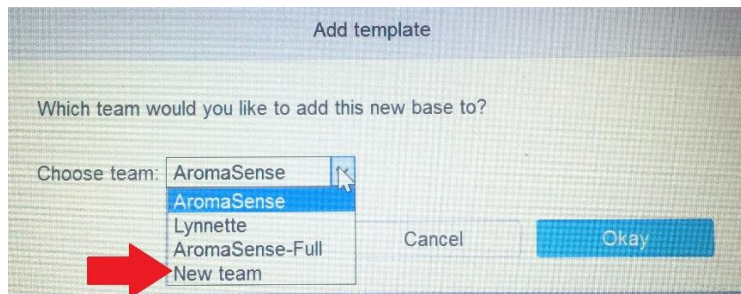

NOTE: If you add your template copy of AromaSense to the AromaSense BASIC team, or to the AromaSense-FULL team IT WILL BE DELETED! YOU MUST CHOOSE NEW TEAM FROM THE DROP DOWN.

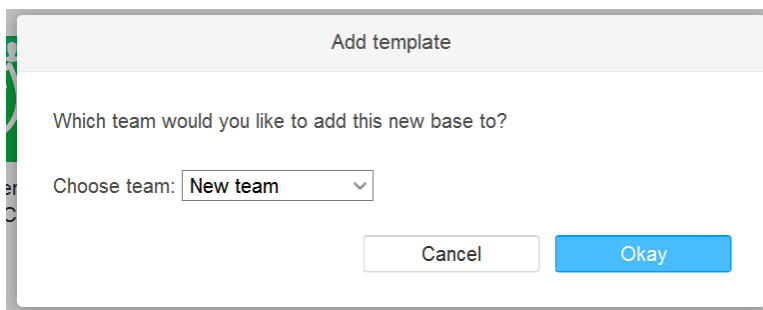

You can name your new team anything you want, your name, "My AromaSense", something to distinguish it as yours.

5. It is THIS new base that you will be using to make your edits and doing all your customization. This is your personal copy of AromaSense.
Edit, create, and enjoy!

You do not have rights to copy and distribute AromaSense to other users. Doing so is theft and violators will be prosecuted.