



2601 S. Douglas Boulevard
Midwest City, Oklahoma 73130

PROPERTY HIGHLIGHTS

- New Construction
- 1st Quarter 2015 Delivery
- 50' Bay Depths
- Drive Thru Available

SUITES AVAILABLE

- Suite 1: 2,000 SF
- Suite 2: 2,000 SF
- Suite 3: 1,500 SF
- Suite 4: 1,500 SF
- Suite 5: 1,500 SF
- Suite 6: 1,500 SF

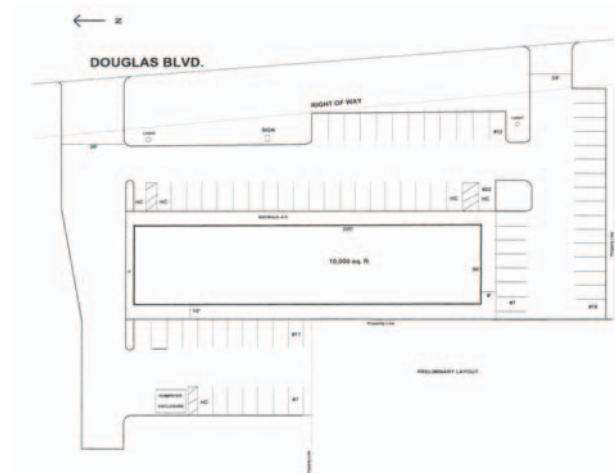

TOTAL SF	10,000 SF MOL
ZONING	Commercial
GENERAL USE	Retail

www.naisullivangroup.com

NO WARRANTY OR REPRESENTATION, EXPRESS OR IMPLIED, IS MADE AS TO THE ACCURACY OF THE INFORMATION CONTAINED HEREIN, AND THE SAME IS SUBMITTED SUBJECT TO ERRORS, OMISSIONS, CHANGE OF PRICE, RENTAL OR OTHER CONDITIONS, PRIOR SALE, LEASE OR FINANCING, OR WITHDRAWAL WITHOUT NOTICE, AND OF ANY SPECIAL LISTING CONDITIONS IMPOSED BY OUR PRINCIPALS NO WARRANTIES OR REPRESENTATIONS ARE MADE AS TO THE CONDITION OF THE PROPERTY OR ANY HAZARDS CONTAINED THEREIN ARE ANY TO BE IMPLIED.

For more information:

David Hartnack
Sam Swanson

David's Cell: 1 405 761 8955
Sam's Cell: 1 405 208 2046
davidh@naisullivangroup.com
sam@naisullivangroup.com

4045 N.W. 64th Street, Suite 340
Oklahoma City, Oklahoma 73116
Office: 1 405 840 0600
Fax: 1 405 840 0610

2601 S. Douglas Boulevard
Midwest City, Oklahoma
73130



DEMOGRAPHICS

Population

1 Mile:	3 Mile:	5 Mile:
3,812	43,844	105,335

Average Household Income

1 Mile:	3 Mile:	5 Mile:
\$58,727	\$54,420	\$53,785

Total Households

1 Mile:	3 Mile:	5 Mile:
1,601	17,644	42,230

LOCATION HIGHLIGHTS

- 1/2 Mile North of Tinker Air Force Base
- 1/2 Mile North of I-40

For more information:

David Hartnack
Sam Swanson

David's Cell: 1 405 761 8955
Sam's Cell: 1 405 208 2046
davidh@naisullivangroup.com
sam@naisullivangroup.com

www.naisullivangroup.com

4045 N.W. 64th Street, Suite 340
Oklahoma City, Oklahoma 73116
Office: 1 405 840 0600
Fax: 1 405 840 0610

NASullivan Group