



6811 S.E. 15th Street

Midwest City, Oklahoma 73110

PROPERTY HIGHLIGHTS

- Former Restaurant
- Cross Parking
- Frontage on 15th Street

LOCATION HIGHLIGHTS

- Dimensions: 174' x 217'
- Frontage: 174' on S.E. 15th Street
- Close Proximity to I-40
- N.E. of Rose State College
- Block West of Midwest City High School
- High Population Density

SUITES AVAILABLE

- Suite B: 3,200 SF



TOTAL SF	8,386 SF MOL
LAND IN ACRES	0.86 MOL
ZONING	C-3
GENERAL USE	Retail
VACANT SF	3,200 SF

www.naisullivangroup.com

NO WARRANTY OR REPRESENTATION, EXPRESS OR IMPLIED, IS MADE AS TO THE ACCURACY OF THE INFORMATION CONTAINED HEREIN, AND THE SAME IS SUBMITTED SUBJECT TO ERRORS, OMISSIONS, CHANGE OF PRICE, RENTAL OR OTHER CONDITIONS, PRIOR SALE, LEASE OR FINANCING, OR WITHDRAWAL WITHOUT NOTICE, AND OF ANY SPECIAL LISTING CONDITIONS IMPOSED BY OUR PRINCIPALS NO WARRANTIES OR REPRESENTATIONS ARE MADE AS TO THE CONDITION OF THE PROPERTY OR ANY HAZARDS CONTAINED THEREIN ARE ANY TO BE IMPLIED.

David Hartnack
Sam Swanson
Nathan Wilson

David's Cell: 1 405 761 8955
 Sam's Cell: 1 405 208 2046
 Nathan's Cell: 1 405 760 5327
davidh@naisullivangroup.com
sam@naisullivangroup.com
nathan@naisullivangroup.com

4045 N.W. 64th Street, Suite 340
 Oklahoma City, Oklahoma 73116
 Office: 1 405 840 0600

6811 S.E. 15th Street
Midwest City, OK 73110



DEMOGRAPHICS

Population		
1 Mile: 11,519	3 Mile: 70,518	5 Mile: 125,289
Average Household Income		
1 Mile: \$48,402	3 Mile: \$53,109	5 Mile: \$54,374
Total Households		
1 Mile: 4,909	3 Mile: 28,644	5 Mile: 49,353

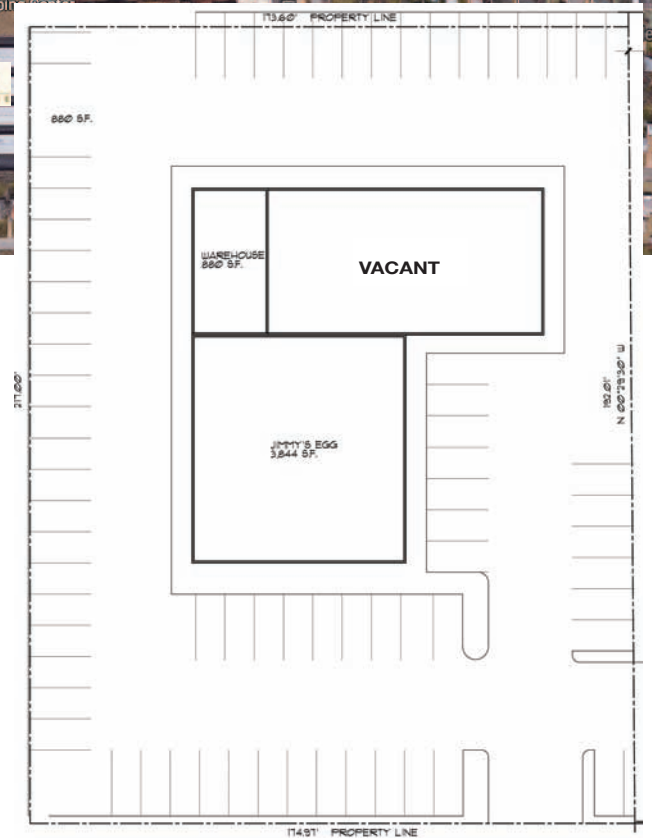

David Hartnack
Sam Swanson
Nathan Wilson

David's Cell: 1 405 761 8955
Sam's Cell: 1 405 208 2046
Nathan's Cell: 1 405 760 5327
davidh@naisullivangroup.com
sam@naisullivangroup.com
nathan@naisullivangroup.com

www.naisullivangroup.com

4045 N.W. 64th Street, Suite 340
Oklahoma City, Oklahoma 73116
Office: 1 405 840 0600
Fax: 1 405 840 0610

NAISullivan Group