



**1543 S.E. 25th Street**

Oklahoma City, Oklahoma 73129

## PROPERTY HIGHLIGHTS

- 9,500 SF Warehouse/Office
- Great Access to I-35 in Oil District
- Fenced Truck Yard with Gravel & Security Lights
- Includes 2,000 SF Offices & Reception Area
- Kitchen & Separate Restrooms
- Shop Restroom & Shower
- New HVAC & Shop Heaters
- New Fiber Optics
- (2) 12' Grade Level Doors
- 12' Clear Ceiling Height
- 220 Volt/3 Phase Power

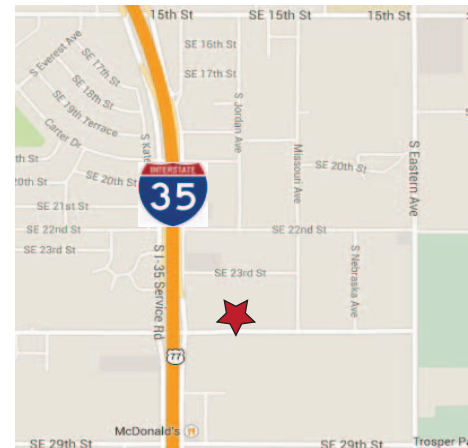

TOTAL SF	9,500 SF MOL
ZONING	I-1
LAND IN ACRES	1.36 MOL
GENERAL USE	Industrial

For more information:

# Darryl Meason

Cell: 1 405 205 9440

darryl@naisullivangroup.com

4045 N.W. 64th Street, Suite 340

Oklahoma City, Oklahoma 73116

Office: 1 405 840 0600

Fax: 1 405 840 0610

[www.naisullivangroup.com](http://www.naisullivangroup.com)

NO WARRANTY OR REPRESENTATION, EXPRESS OR IMPLIED, IS MADE AS TO THE ACCURACY OF THE INFORMATION CONTAINED HEREIN, AND THE SAME IS SUBMITTED SUBJECT TO ERRORS, OMISSIONS, CHANGE OF PRICE, RENTAL OR OTHER CONDITIONS, PRIOR SALE, LEASE OR FINANCING, OR WITHDRAWAL WITHOUT NOTICE, AND OF ANY SPECIAL LISTING CONDITIONS IMPOSED BY OUR PRINCIPALS NO WARRANTIES OR REPRESENTATIONS ARE MADE AS TO THE CONDITION OF THE PROPERTY OR ANY HAZARDS CONTAINED THEREIN ARE ANY TO BE IMPLIED.

1543 S.E. 25th Street  
Oklahoma City, Oklahoma  
73129



## DEMOGRAPHICS

### Population

1 Mile: 3,594	3 Mile: 74,151	5 Mile: 225,172
------------------	-------------------	--------------------

### Average Household Income

1 Mile: \$51,583	3 Mile: \$50,742	5 Mile: \$52,857
---------------------	---------------------	---------------------

### Total Households

1 Mile: 1,794	3 Mile: 29,018	5 Mile: 84,028
------------------	-------------------	-------------------

## LOCATION HIGHLIGHTS

- Dimensions: 125' x 474'
- Frontage: 125' on S.E. 25th Street
- Easy Access to I-35

For more information:

**Darryl Meason**

Cell: 1 405 205 9440

darryl@naisullivangroup.com

[www.naisullivangroup.com](http://www.naisullivangroup.com)



4045 N.W. 64th Street, Suite 340  
Oklahoma City, Oklahoma 73116  
Office: 1 405 840 0600  
Fax: 1 405 840 0610