



Smaller Parcels Slightly Higher in Price

## 1800 Block S. Country Club Road

El Reno, Oklahoma 73036

### PROPERTY HIGHLIGHTS

- 4 Acres MOL just South of Family Video
- Prominent Location on the Popular East Side of Country Club
- Favorable "CAR" Zoning equivalent to C-3
- Flat Land
- Excellent Visibility
- City Utilities
- Great Location for a Restaurant or Retail

TOTAL SF	174,240 SF MOL
ZONING	CAR, Commercial
LAND IN ACRES	4 MOL
GENERAL USE	Retail
2012 TAXES	\$195.59

[www.naisullivangroup.com](http://www.naisullivangroup.com)

NO WARRANTY OR REPRESENTATION, EXPRESS OR IMPLIED, IS MADE AS TO THE ACCURACY OF THE INFORMATION CONTAINED HEREIN, AND THE SAME IS SUBMITTED SUBJECT TO ERRORS, OMISSIONS, CHANGE OF PRICE, RENTAL OR OTHER CONDITIONS, PRIOR SALE, LEASE OR FINANCING, OR WITHDRAWAL WITHOUT NOTICE, AND OF ANY SPECIAL LISTING CONDITIONS IMPOSED BY OUR PRINCIPALS NO WARRANTIES OR REPRESENTATIONS ARE MADE AS TO THE CONDITION OF THE PROPERTY OR ANY HAZARDS CONTAINED THEREIN ARE ANY TO BE IMPLIED.

For more information:

**Irmon Gray**

**Lee Bollinger, CCIM**

Irmon's Cell: 1 405 474 7286

Lee's Cell: 1 405 202 3926

[irmon@naisullivangroup.com](mailto:irmon@naisullivangroup.com)

[lee@naisullivangroup.com](mailto:lee@naisullivangroup.com)

4045 N.W. 64th Street, Suite 340

Oklahoma City, Oklahoma 73116

Office: 1 405 840 0600

Fax: 1 405 840 0610

1800 Block S. Country Club  
Road  
El Reno, Oklahoma  
73036

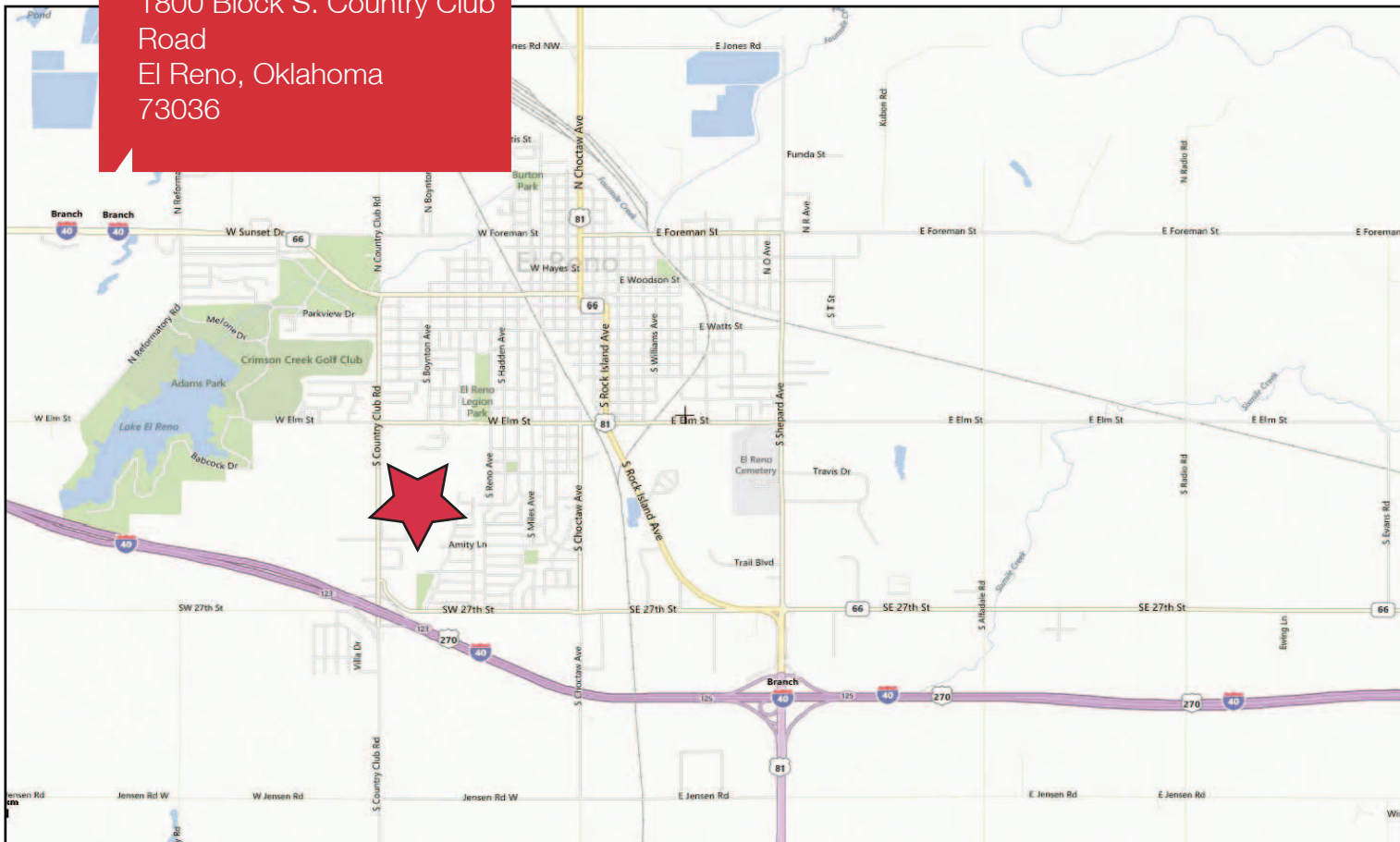

## DEMOGRAPHICS

### Population

<b>1 Mile:</b> 6,347	<b>3 Mile:</b> 16,185	<b>5 Mile:</b> 16,713
-------------------------	--------------------------	--------------------------

### Average Household Income

<b>1 Mile:</b> \$51,794	<b>3 Mile:</b> \$53,212	<b>5 Mile:</b> \$53,646
----------------------------	----------------------------	----------------------------

### Total Households

<b>1 Mile:</b> 2,495	<b>3 Mile:</b> 5,698	<b>5 Mile:</b> 5,891
-------------------------	-------------------------	-------------------------

## LOCATION HIGHLIGHTS

- Frontage: 400' on Country Club Road
- Dimensions: 400' x 435.6'
- High Traffic Area
- Easy Access to I-40, Downtown, Golf Course & Shopping
- First Developing Area between Elm & 27th Street

For more information:

**Irmon Gray**  
**Lee Bollinger, CCIM**

Irmon's Cell: 1 405 474 7286  
Lee's Cell: 1 405 202 3926  
irmon@naisullivangroup.com  
lee@naisullivangroup.com

[www.naisullivangroup.com](http://www.naisullivangroup.com)

4045 N.W. 64th Street, Suite 340  
Oklahoma City, Oklahoma 73116  
Office: 1 405 840 0600  
Fax: 1 405 840 0610

**NAISullivan Group**