



## 617 & 619 N. Post Road

Oklahoma City, Oklahoma 73130

### PROPERTY HIGHLIGHTS

- Located Just North of I-40
- South of Spencer Between Choctaw & Midwest City
- Oklahoma City Public Schools
- Developing Area

LAND IN ACRES	0.80 MOL
ZONING	Residential
GENERAL USE	Residential
2013 TAXES	\$91.21 (Both Parcels)

[www.naisullivangroup.com](http://www.naisullivangroup.com)

NO WARRANTY OR REPRESENTATION, EXPRESS OR IMPLIED, IS MADE AS TO THE ACCURACY OF THE INFORMATION CONTAINED HEREIN, AND THE SAME IS SUBMITTED SUBJECT TO ERRORS, OMISSIONS, CHANGE OF PRICE, RENTAL OR OTHER CONDITIONS, PRIOR SALE, LEASE OR FINANCING, OR WITHDRAWAL WITHOUT NOTICE, AND OF ANY SPECIAL LISTING CONDITIONS IMPOSED BY OUR PRINCIPALS NO WARRANTIES OR REPRESENTATIONS ARE MADE AS TO THE CONDITION OF THE PROPERTY OR ANY HAZARDS CONTAINED THEREIN ARE ANY TO BE IMPLIED.

For more information:

**Bob Sullivan, CCIM**

Cell: 1 405 641 9798  
rsullivan@ccim.net

4045 N.W. 64th Street, Suite 340  
Oklahoma City, Oklahoma 73116  
Office: 1 405 840 0600  
Fax: 1 405 840 0610

617 & 619 N. Post Road  
Oklahoma City, Oklahoma  
73130

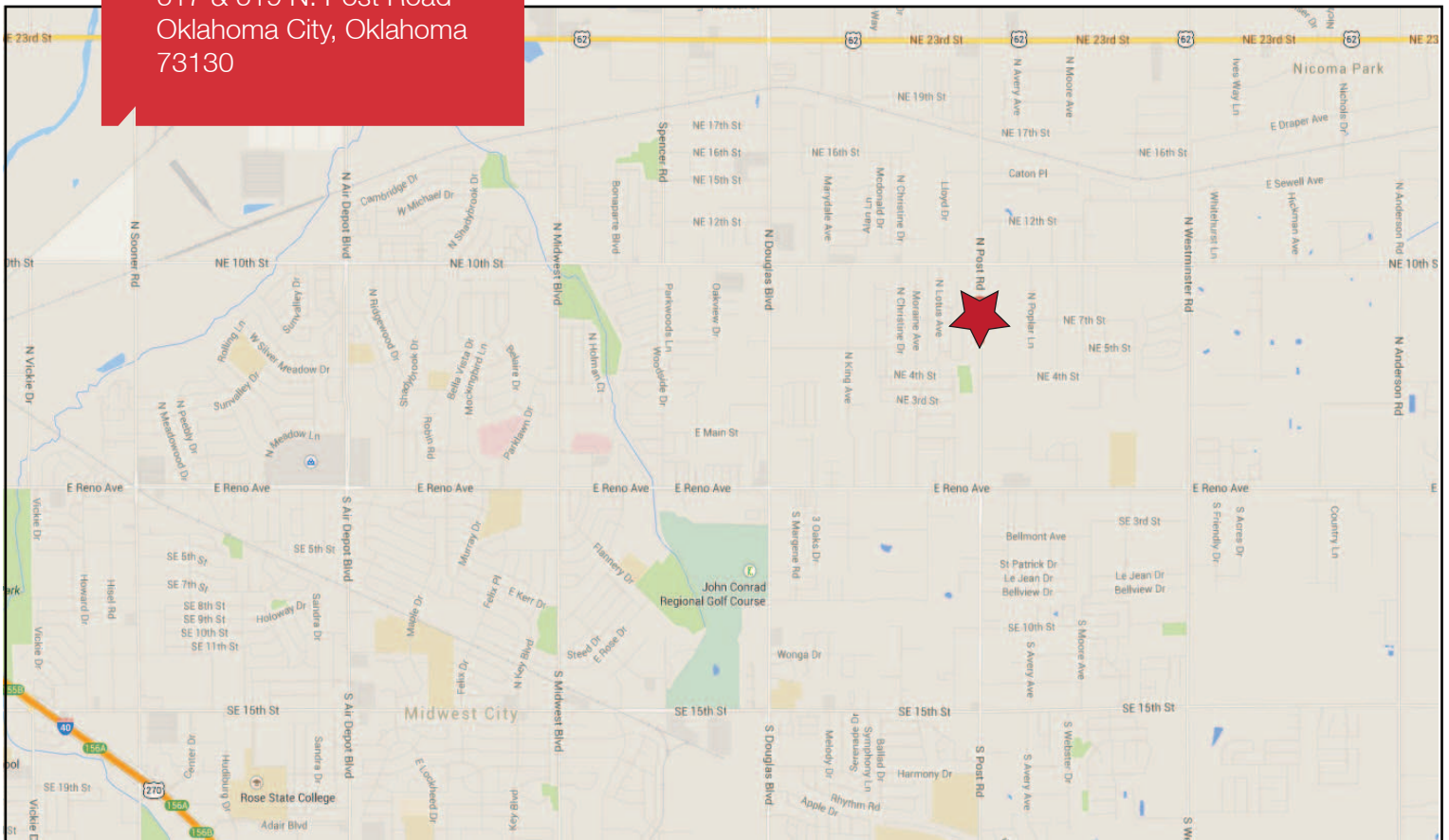

## DEMOGRAPHICS

### Population

1 Mile:	3 Mile:	5 Mile:
6,494	46,511	79,365

### Average Household Income

1 Mile:	3 Mile:	5 Mile:
\$49,947	\$54,105	\$55,135

### Total Households

1 Mile:	3 Mile:	5 Mile:
2,518	19,108	32,348

## LOCATION HIGHLIGHTS

- Dimensions: 122' x 285'
- Just North of I-40 & Post Road

For more information:

**Bob Sullivan, CCIM**

Cell: 1 405 641 9798

rsullivan@ccim.net

[www.naisullivangroup.com](http://www.naisullivangroup.com)

**NAI Sullivan Group**

4045 N.W. 64th Street, Suite 340  
Oklahoma City, Oklahoma 73116  
Office: 1 405 840 0600  
Fax: 1 405 840 0610