



13924 Wireless Way

Oklahoma City, Oklahoma 73134

PROPERTY HIGHLIGHTS

- Fronts Wireless Way
- Fully Developed with 35 Parking Spaces
- Easy Access to Kilpatrick Turnpike
- Ideal for Office/Medical Building

TOTAL SF	22,877 SF MOL
ZONING	C-3
GENERAL USE	Commercial/Office
LAND IN ACRES	0.53 ACRES MOL

For more information:

www.naisullivangroup.com

Ana Nix

Cell: 1 405 830 3558

ana@naisullivangroup.com

4045 N.W. 64th Street, Suite 340

Oklahoma City, Oklahoma 73116

Office: 1 405 840 0600

Fax: 1 405 840 0610

NO WARRANTY OR REPRESENTATION, EXPRESS OR IMPLIED, IS MADE AS TO THE ACCURACY OF THE INFORMATION CONTAINED HEREIN, AND THE SAME IS SUBMITTED SUBJECT TO ERRORS, OMISSIONS, CHANGE OF PRICE, RENTAL OR OTHER CONDITIONS, PRIOR SALE, LEASE OR FINANCING, OR WITHDRAWAL WITHOUT NOTICE, AND OF ANY SPECIAL LISTING CONDITIONS IMPOSED BY OUR PRINCIPALS NO WARRANTIES OR REPRESENTATIONS ARE MADE AS TO THE CONDITION OF THE PROPERTY OR ANY HAZARDS CONTAINED THEREIN ARE ANY TO BE IMPLIED.

13924 Wireless Way
Oklahoma City, Oklahoma
73134



DEMOGRAPHICS

Population		
1 Mile: 4,791	3 Mile: 56,850	5 Mile: 146,689
Average Household Income		
1 Mile: \$70,722	3 Mile: \$56,155	5 Mile: \$59,287
Total Households		
1 Mile: 2,363	3 Mile: 26,765	5 Mile: 63,116

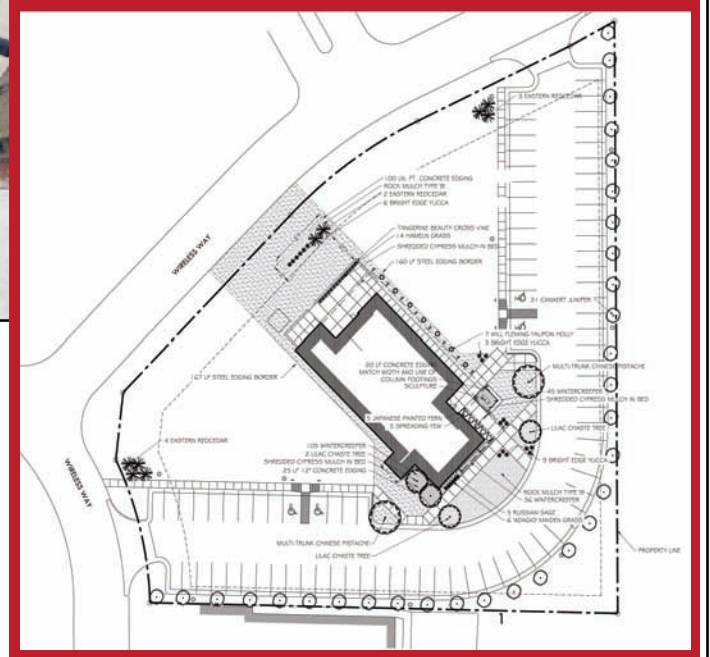

LOCATION HIGHLIGHTS

- Located in the Rapidly Developing Area of May Avenue & Memorial Road
- Abundant Residential, Office, Retail & Hospitality in the Immediate Area
- Approximately 1.5 Miles from Mercy Health Center

For more information:

Ana Nix

Cell: 1 405 830 3558
ana@naisullivangroup.com

www.naisullivangroup.com

4045 N.W. 64th Street, Suite 340
Oklahoma City, Oklahoma 73116
Office: 1 405 840 0600
Fax: 1 405 840 0610

