



# 266-288 Central Avenue

Newark, NJ

## Building Size

- 2,500 SF with Drive-Thru
- 6,468 SF Retail Building

## Type

- Ground Lease or Conventional

## Zone

- RDV/SD (Redevelopment Zone/Special District)

## Traffic Count

- 12,793 VPD

## Demographics

Radius	Population	Daytime Population	Average HH Income
.5 Mile	13,886	22,672	\$44,165
1 Mile	49,677	111,967	\$44,631
1.5 Mile	118,890	188,438	\$48,991

## Retail For Lease

Contact:

Jason Pierson  
Ph. 732.707.6900 ext. 1  
jason@piersonre.com

Ryan Starkman  
Ph. 732.707.6900 ext. 5  
ryan@piersonre.com

**PIERSON**  
COMMERCIAL REAL ESTATE



# 266-288 Central Avenue

Newark, NJ

- Potential fast food with drive-thru or retail strip redevelopment in the heart of Newark's redevelopment zone.
- Strategically located at the hard corner of a two-traffic light controlled intersection fronting Central Avenue with over 20,000 vehicles per day along Central Avenue and Norfolk Street.
- Directly adjacent to NJIT campus and Norfolk Street Station.
- New office development to the rear of the property.
- Pent up demand for retail in Newark as majority of residents purchases are made outside the city resulting in a significant annual retail leakage.



Option "A"

Option "B"

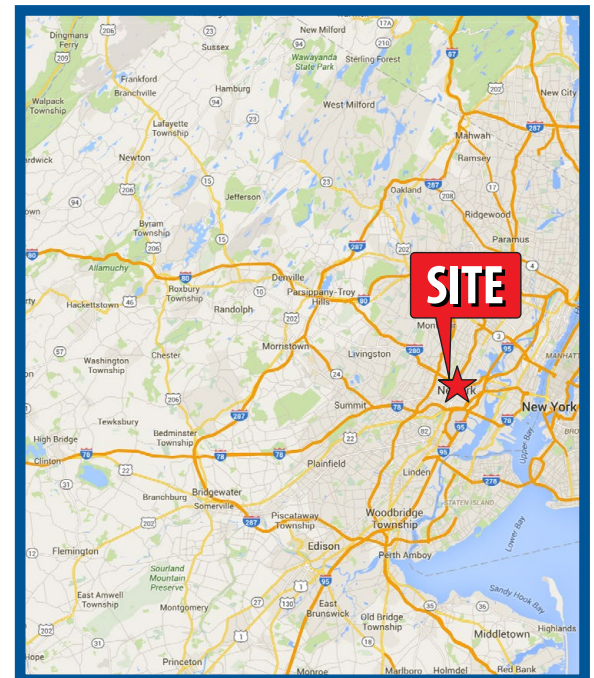
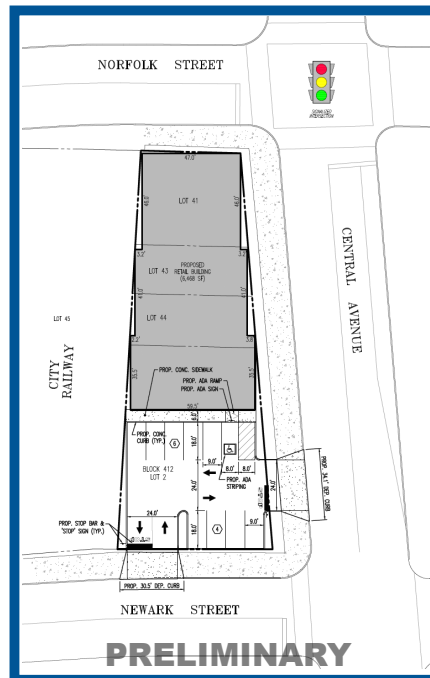
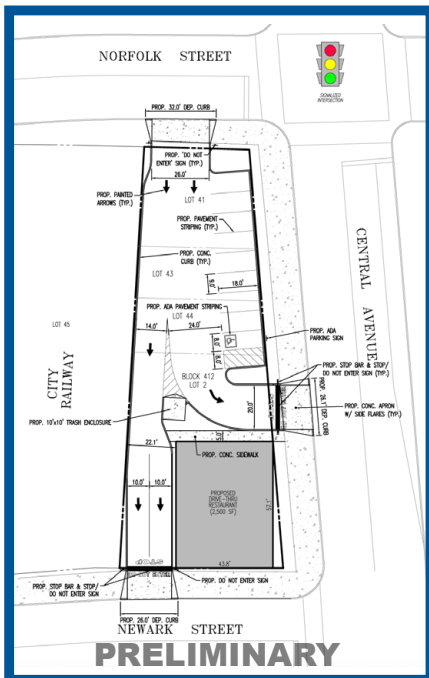

## Retail For Lease

Contact:

Jason Pierson

Ph. 732.707.6900 ext. 1

jason@piersonre.com

Ryan Starkman

Ph. 732.707.6900 ext. 5

ryan@piersonre.com

**PIERSON**  
COMMERCIAL REAL ESTATE