

# MT - SP Series

## Regenerative Turbine Self-Primer Pumps

The same basic features of MT pumps apply to the MT-SP series design with the addition of a self-contained, self-priming pump casing. MT-SP pumps provide smooth, continuous, leak-proof operation where top unloading is required.

### Performances

- Flows to 60 GPM (14 m<sup>3</sup>/h)
- Heads to 180 FT (50 m)
- System pressures to 110 PSIG (8 bar)
- Temperatures to: 230°F (110°C)

### Options

- Dual containment shell

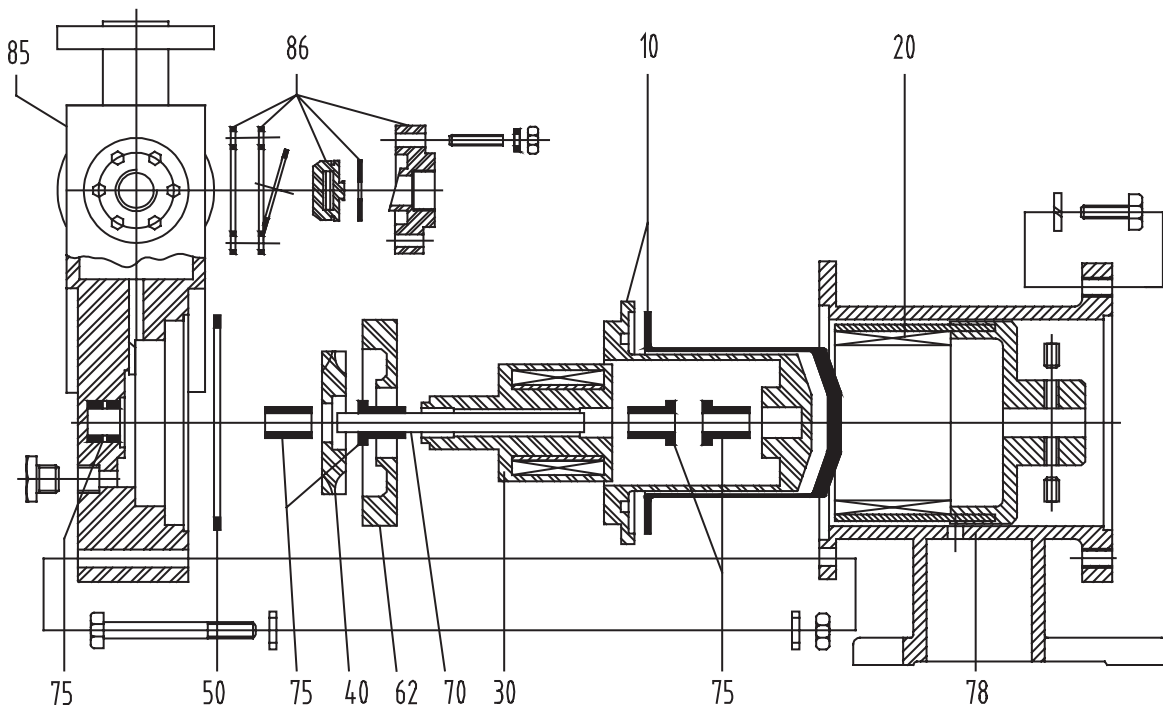

#### PARTS LIST

10	Rear Casing
20	External Magnet
30	Internal Magnet
40	Impeller
50	O-ring
62	Rear Ring
70	Shaft
75	Bearings
78	Bracket
85	Pump Head
86	Check Valve + Gasket set
88	Rear Wet End (kit + rear casing)
90	Wet End

## MTSP Dimensions & Specifications

### MTSP with Foot Mounted Motor

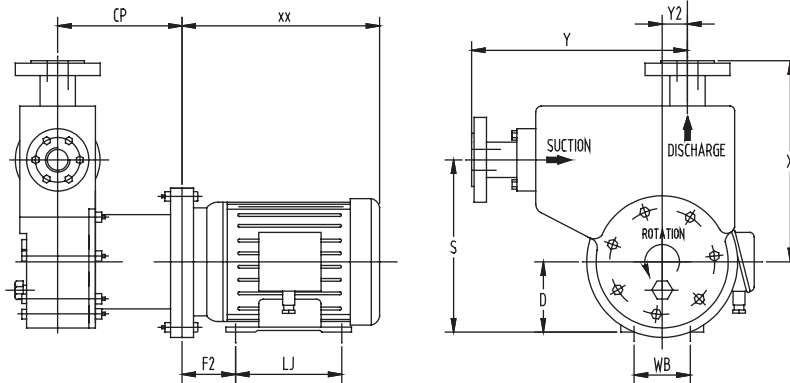

### MTSP with Pedestal Mounted Motor

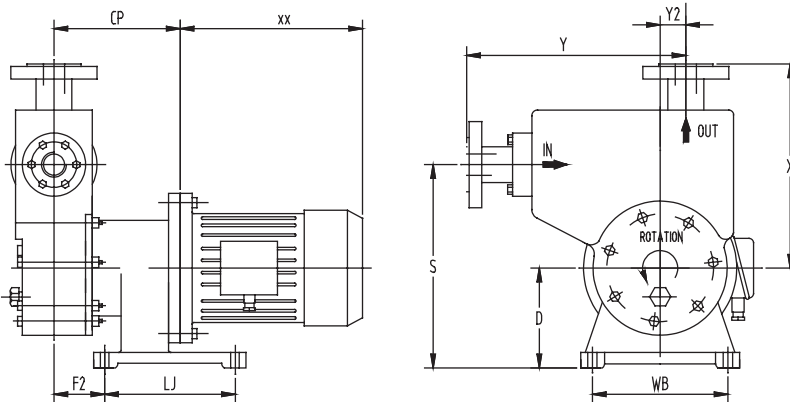

MODEL NO.	SUCTION		DISCHARGE		D	S	X	Y	Y2	CP	F2	LJ	WB
	NPT	FLANGE	NPT	FLANGE									
MTSP 2503	1/2"		1/2"		2.50	6.75	6.50	6.13	0.62	4.75	N/A	N/A	N/A
MTSP 3503	3/4"		3/4"		2.79	7.04	6.69	6.77	0.66	5.66	N/A	N/A	N/A
MTSP 5503	1"		1"		3.14	7.40	6.69	6.77	0.66	6.18	N/A	N/A	N/A
MTSP 7503	1"		1"		5.35	11.33	8.93	8.22	0.25	7.51	2.87	7.59	6.10
MTSP 9502	1"		1"		5.35	11.33	8.93	8.22	0.25	7.51	2.87	7.59	6.10
MTSP 16502	1 1/4"		1 1/4"		7.87	14.56	10.23	10.03	0.86	9.64	2.79	11.41	9.84
MTSP 2503		1/2" 150# RF ANSI		1/2" 150# RF ANSI	2.50	6.75	8.25	7.87	0.62	4.75	N/A	N/A	N/A
MTSP 3503		3/4" 150# RF ANSI		3/4" 150# RF ANSI	2.79	7.04	8.50	8.58	0.66	5.66	N/A	N/A	N/A
MTSP 5503		1" 150# RF ANSI		1" 150# RF ANSI	3.14	7.40	8.50	8.58	0.66	6.18	N/A	N/A	N/A
MTSP 7503		1" 150# RF ANSI		1" 150# RF ANSI	5.35	11.33	10.74	10.03	0.25	7.51	2.87	7.59	6.10
MTSP 9502		1" 150# RF ANSI		1" 150# RF ANSI	5.35	11.33	10.74	10.03	0.25	7.51	2.87	7.59	6.10
MTSP 16502		1 1/4" 150# RF ANSI		1 1/4" 150# RF ANSI	7.87	14.56	12.40	12.12	0.86	9.64	2.79	11.41	9.84

# MTSP - Series

MODEL NO. PP / TEFC	PORT SIZES SUCTION/DISCH	PERFORMANCES GPM/TDH (MAX)	MATERIALS PUMP, O-RING	MAX (PSIG) STD/DUAL CF	MAX TEMP (F) PP/PVDF RWE	POWER (HP)	PUMP FRAME NEMA SIZE	WT (LBS.) PUMP END
MTSP2503-P1T3	1/2" x 1/2" FNPT	9 / 47'	PP, EPDM	110	140 / 180	1/3 or 1/2 HP	56-C	10
MTSP2503-P1F3	1/2" x 1/2" FLANGE	9 / 47"	PP, EPDM	110	140 / 180	1/3 or 1/2 HP	56-C	10
MTSP3503-P2T3	3/4" x 3/4" FNPT	15 / 110'	PP, EPDM	110	140 / 180	3/4 or 1 HP	56-C	10
MTSP3503-P2F3	3/4" x 3/4" FLANGE	15 / 110'	PP, EPDM	110	140 / 180	3/4 or 1 HP	56-C	11
MTSP5503-P2T3	1" x 1" FNPT	25 / 130'	PP, EPDM	110	140 / 180	1-1/2 or 2 HP	143/5-TC	13
MTSP5503-P2F3	1" x 1" FLANGE	25 / 130'	PP, EPDM	110	140 / 180	1-1/2 or 2 HP	143/5-TC	14
MTSP7503-P2T3	1" x 1" FNPT	31 / 160'	PP, EPDM	110 / 150	140 / 180	3 or 5 HP	182/4-TC	70
MTSP7503-P2F3	1" x 1" Flanges	31 / 160'	PP, EPDM	110 / 150	140 / 180	3 or 5 HP	182/4-TC	70
MTSP9502-P2T3	1" x 1" FNPT	45 / 160'	PP, EPDM	110 / 150	140 / 180	5 or 7-1/2 HP	182/4-TC	70
MTSP9502-P2F3	1" x 1" Flanges	45 / 160'	PP, EPDM	110 / 150	140 / 180	5 or 7-1/2 HP	182/4-TC	70
MTSP16502-P2T3	1 1/4" x 1 1/4" FNPT	60 / 160'	PP, EPDM	110 / 150	140 / 180	10 or 15 HP	213/5, 254/6-TC	105
MTSP16502-P2F3	1 1/4" x 1 1/4" Flanges	60 / 160'	PP, EPDM	110 / 150	140 / 180	10 or 15 HP	213/5, 254/6-TC	105

MODEL NO. PVDF / TEFC	PORT SIZES SUCTION/DISCH	PERFORMANCES GPM / TDH (MAX)	MATERIALS PUMP, O-RING	MAX (PSIG) STD/DUAL CF	MAX TEMP (F) PVDF	POWER (HP)	PUMP FRAME NEMA SIZE	WT (LBS.) PUMP END
MTSP2503-V1T3	1/2" x 1/2" FNPT	9 / 47'	PVDF, VITON	110	180	1/3 or 1/2 HP	56-C	14
MTSP2503-V1F3	1/2" x 1/2" Flanges	9 / 47'	PVDF, VITON	110	180	1/3 or 1/2 HP	56-C	15
MTSP3503-V2T3	3/4" x 3/4" FNPT	15 / 110'	PVDF, VITON	110	180	3/4 or 1 HP	56-C	14
MTSP3503-V2F3	3/4" x 3/4" Flanges	15 / 110'	PVDF, VITON	110	180	3/4 or 1 HP	56-C	15
MTSP5503-V2T3	1" x 1" FNPT	25 / 130'	PVDF, VITON	110	180	1-1/2 or 2 HP	143/5-TC	17
MTSP5503-V2F3	1" x 1" Flanges	25 / 130'	PVDF, VITON	110	180	1-1/2 or 2 HP	143/5-TC	18
MTSP7503-V2T3	1" x 1" FNPT	31 / 160'	PVDF, VITON	110 / 150	180	3 or 5 HP	182/4-TC	76
MTSP7503-V2F3	1" x 1" Flanges	31 / 160'	PVDF, VITON	110 / 150	180	3 or 5 HP	182/4-TC	77
MTSP9502-V2T3	1" x 1" FNPT	45 / 160'	PVDF, VITON	110 / 150	180	5 or 7-1/2 HP	182/4-TC	76
MTSP9502-V2F3	1" x 1" Flanges	45 / 160'	PVDF, VITON	110 / 150	180	5 or 7-1/2 HP	182/4-TC	77
MTSP16502-V2T3	1" x 1" FNPT	60 / 160'	PVDF, VITON	110 / 150	180	10 or 15 HP	213/5-TC or 254/6-TC	121
MTSP16502-V2F3	1" x 1" Flanges	60 / 160'	PVDF, VITON	110 / 150	180	10 or 15 HP	213/5-TC or 254/6-TC	123
MTSP16503-V2T3	1 1/4" x 1 1/4" FNPT	60 / 180'	PVDF, VITON	110 / 150	180	10 or 15 HP	213/5-TC or 254/6-TC	121
MTSP16503-V2F3	1 1/4" x 1 1/4" Flanges	60 / 180'	PVDF, VITON	110 / 150	180	10 or 15 HP	213/5-TC or 254/6-TC	123

## 3500 RPM

